



Lista de precios Euro
Listino prezzi Euro
Price list Euro

PE 100 Pression

Elementos de unión
Piezas moldeadas

Parti per collegamento
Raccordi a bicchiere

Connection elements
Spigot fittings

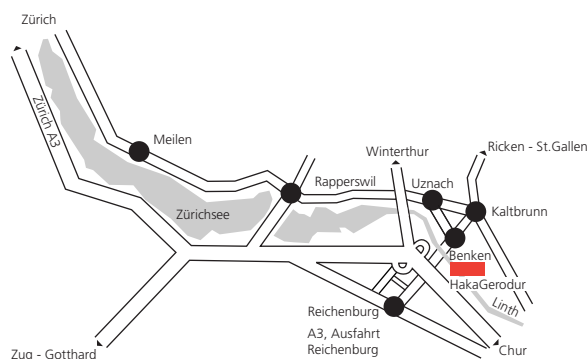

Dove trovarci
Dónde nos encuentra
How To Find Us

HakaGerodur AG
Giessenstrasse 3
Postfach
CH-8717 Benken
Telefon +41 (0)55 293 25 25
Fax +41 (0)55 293 25 26
sekretariat@hakagerodur.ch
www.hakagerodur.ch

Quando contattarci

lunedì-giovedì:
ore 7.15–12.00 | 13.00–17.15
venerdì:
ore 7.15–12.00 | 13.00–17.00

Come ordinare fuori degli orari d'ufficio

Fax +41 (0)55 293 25 26
e-mail: sekretariat@hakagerodur.ch

Nostre condizioni di vendita

Fornitura: secondo le nostre condizioni generali di vendita

Termine di consegna: da magazzino o a breve termine, salvo il venduto

Prezzi: lordi, escl. IVA e imballo

Sconti: a richiesta

Con riserva di modifiche di prezzo, prodotto ed assortimento

Trovate le nostre condizioni generali di vendita al sito:
www.hakagerodur.ch/agbe.pdf

Estamos a su disposición

Lunes-jueves de
7.15–12.00 | 13.00–17.15 h
viernes de
7.15–12.00 | 13.00–17.00 h

Cómo efectuar sus pedidos fuera del horario de oficina

Fax +41 (0)55 293 25 26
E-Mail: sekretariat@hakagerodur.ch

Nuestras condiciones venta

Suministro: según nuestras Condiciones Generales de Venta

Plazo de entrega: disponible en nuestro almacén o plazo breve de entrega, salvo en caso de venta anterior

Precios: bruto, IVA y embalaje no incluidos

Rebajas: consultar

Bajo reserva de modificaciones de precios, productos y surtido

Hallará nuestras Condiciones Generales de Venta en nuestro sitio web:
www.hakagerodur.ch/agbe.pdf

When you can contact us

Monday-Thursday:
7.15am–12 noon | 1pm–5.15pm
Friday:
7.15am–12 noon | 1pm–5pm

How to place an order outside office hours:

Fax +41 (0)55 293 25 26
E-Mail: sekretariat@hakagerodur.ch

Our Terms and Conditions

Delivery: in accordance with our General Terms and Conditions of Sale

Delivery time: ex-stock, or available in the short term, subject to sale

Prices: gross, excluding VAT and packing

Discount: quote provided upon request

We reserve the right to vary the price, the product and the range

The General Terms and Conditions of Sale can be reviewed on:
www.hakagerodur.ch/agbe.pdf

Índice
Indice
Table of contents

	Página Pagina
Sistema modular ELGEF® Plus Sistema modulare ELGEF® Plus Modular System ELGEF® Plus	2
Uniones para soldadura eléctrica Raccordi per elettrosaldatura Electrofusion fittings	5
Adaptadores/reductores PE/rosca Adattatori-riduttori PE/filettatura Transition PE/thread	10
Aparatos de soldadura eléctrica Apparecchiature per elettrosaldatura Electrofusion control unit	13
Unión en Y para sondas geotérmicas Raccordo a Y per sonde geotermiche Y-piece for geothermal probes/borehole heat exchangers	15
Uniones de espitas para soldadura eléctrica y soldadura a tope Raccordi a bicchiere per elettrosaldatura e saldatura di testa Spigot fittings for electrofusion and butt-welding	16
Bridas libres Flange libere Slip-on flanges	26
Uniones de espita ángulo 11°–30° Raccordi bicchiere Gomito 11°–30° Spigot fittings Elbow 11°–30°	28
Piezas de conexión por manguito roscado Bocchettoni con manicotto a vite Screwing sleeve socket	32
POLYRAC® Uniones de compresión POLYRAC® Raccordi di serraggio POLYRAC® Compression fittings	33

Sistema modular ELGEF® Plus

Sistema modular de abrazaderas



Sistema modular adaptadores/reductores

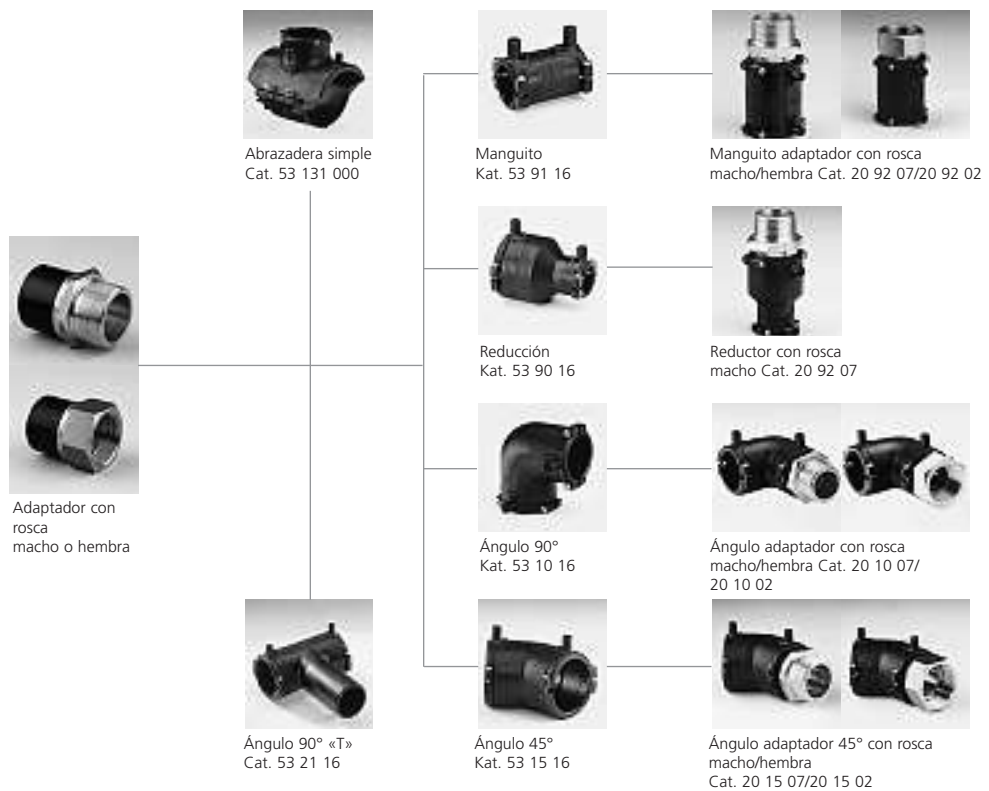

Sistema modulare ELGEF® Plus

Sistema modulare collari

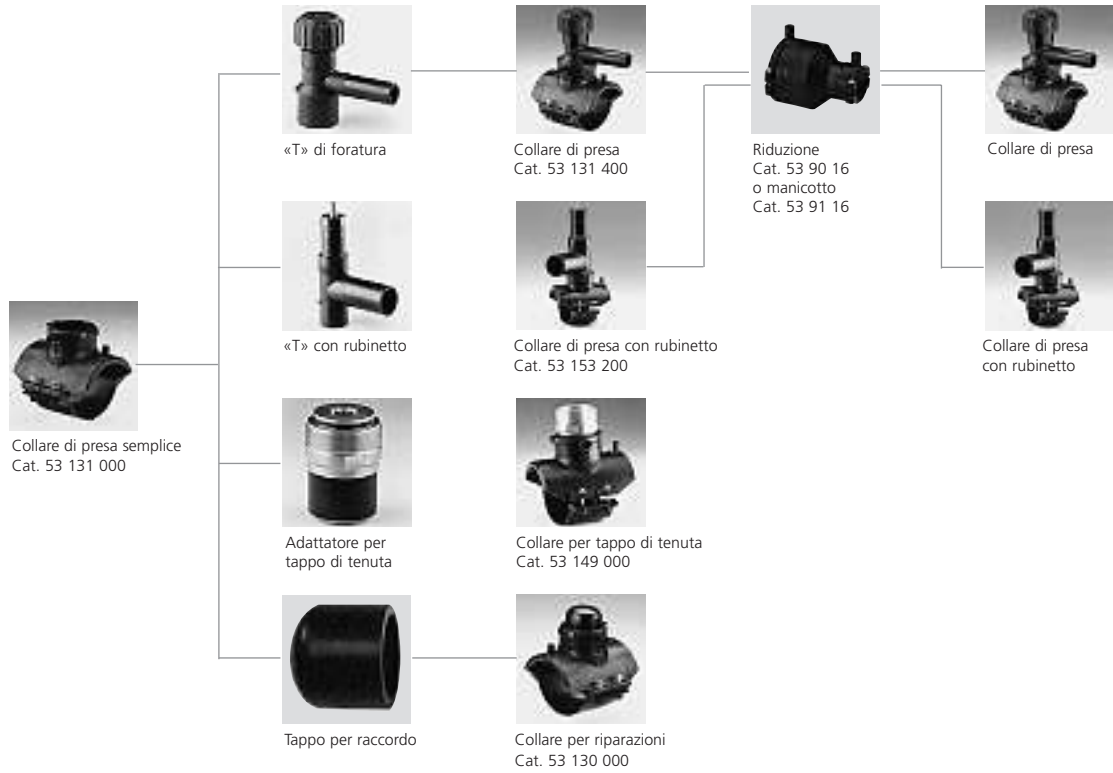

Sistema modulare adattatori-riduttori



Modular System ELGEF® Plus

Modular System Saddles



Modular Transition Fitting System

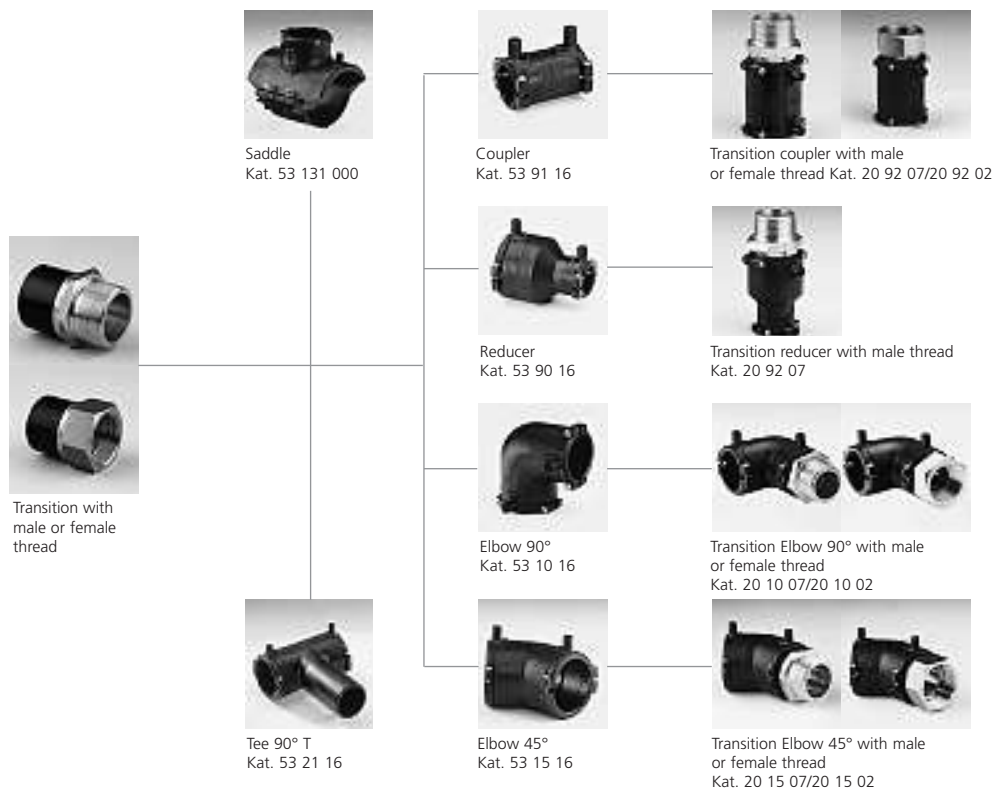

ELGEF® Plus Manguito para soldadura eléctrica con dispositivo de sujeción incorporado

ELGEF® Plus Manicotto per elettrosaldatura con fermo incorporato

ELGEF® Plus electrofusion coupler with integrated holder

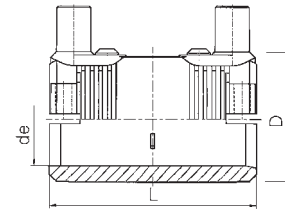

N° art. N. Articolo Article no	de mm	L mm	D mm	GP		Peso Peso Weight kg	NPK CAN	Código	Precio Prezzo Price EUR/unid.
S 5/PN 16/SDR 11									
04.7200	20	68	31	50		0.056		753 911 606	5.50
04.7201	25	68	36	50		0.067		753 911 607	5.50
04.7202	32	72	44	50		0.079	431 512	753 911 608	6.70
04.7203	40	80	54	50		0.107	431 513	753 911 609	6.80
04.7204	50	88	66	10		0.165	431 514	753 911 610	10.-
04.7205	63	96	81	10		0.210	431 515	753 911 611	10.50

ELGEF® Plus Manguito para soldadura eléctrica sin dispositivo de sujeción incorporado

ELGEF® Plus Manicotto per elettrosaldatura senza fermo incorporato

ELGEF® Plus electrofusion Coupler without integrated holder

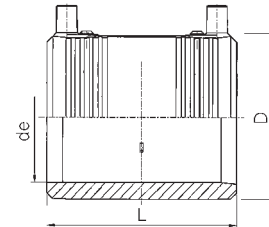

N° art. N. Articolo Article no	de mm	L mm	D mm	GP		Peso Peso Weight kg	NPK CAN	Código	Precio Prezzo Price EUR/unid.
S 5/PN 16/SDR 11									
04.7206	75	110	96	10		0.321	431 516	753 911 612	16.60
04.7207	90	125	113	10		0.455	431 517	753 911 613	20.70
04.7208	110	145	138	5		0.761	431 518	753 911 614	22.90
04.7209	125	158	155	5		1.025	431 519	753 911 615	31.80
04.7950	140	170	175	2		1.570	431 521	753 911 616	35.30
04.7210	160	180	197	5		1.828	431 522	753 911 617	47.90
04.7211	180	194	220	1		2.637	431 523	753 911 618	72.20
04.7212	200	208	245	1		3.323	431 524	753 911 619	79.90
04.7213	225	224	276	1		4.435	431 525	753 911 620	113.40
04.7214	250	225	325	1		5.588	431 526	753 911 621	166.70
04.7600	280	225	365	1		7.353	431 527	753 911 622	235.20
04.7215	315	225	405	1		9.121	431 528	753 911 623	284.60
04.7601	355	245	425	1		12.633	431 529	753 911 624	418.50
04.7602	400	245	490	1		16.516	431 530	753 911 625	513.60
S 8/PN 10/SDR 17									
04.8810	160	190	186	-		1.050		753 911 817	42.40
04.8811	180	200	210	-		1.350		753 911 818	58.40
04.8812	200	210	228	-		1.700		753 911 819	72.-
04.8813	225	220	266	2		2.290		753 911 820	89.80
04.7603	250	247	287	2		3.870	431 526	753 911 821	134.70
04.8817	280	249	334	1		5.600		753 911 822	187.20
04.7604	315	271	360	1		6.454		753 911 823	205.20
04.7605	355	246	414	1		9.000	431 528	753 911 824	287.60
04.8814	400	246	463	1		10.023		753 911 825	388.10
04.8815	450	290	522	1		16.023		753 911 826	657.40
04.8816	500	290	579	1		19.523		753 911 827	711.50

ELGEF® Plus Ángulo 90° para soldadura eléctrica con dispositivo de sujeción incorporado

ELGEF® Plus Gomito 90° per elettrosaldatura con fermo incorporato

ELGEF® Plus electrofusion Elbow 90° with integrated holder

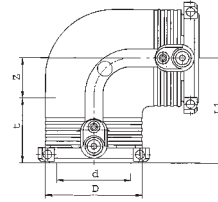

N° art. N. Articolo Article no	de mm	L1 mm	D mm	t mm	z mm	GP	Peso Peso Weight kg	NPK CAN	Código	Precio Prezzo Price EUR/unid.
S 5/PN 16/SDR 11										
04.8836	20	54	35	34	20	10	0.093		753 101 606	15.70
04.8837	25	54	35	34	20	10	0.078		753 101 607	15.70
04.7620	32	53	44	36	17	10	0.114	431 112	753 101 608	15.70
04.7621	40	62	54	39	23	10	0.158	431 113	753 101 609	18.80
04.7622	50	71	66	43	28	10	0.215	431 114	753 101 610	23.70
04.7623	63	81	81	48	32	10	0.314	431 115	753 101 611	27.10
sin dispositivo de sujeción incorporado/senza fermo incorporato/without integrated holder										
04.7699	75	101	97	61	40	10	0.530	431 116	753 101 812	28.80
04.7624	90	110	113	62	48	10	0.752	431 117	753 101 813	47.90
04.7625	110	132	136	71	61	10	1.482	431 118	753 101 814	68.80
04.7626	125	142	151	74	68	5	1.828	431 119	753 101 815	95.90
04.7627	160	178	196	92	86	4	2.615	431 122	753 101 817	189.50
04.8838	180	195	219	95	100	4	4.755	431 123	753 101 818	260.30

ELGEF® Plus Ángulo 45° para soldadura eléctrica con dispositivo de sujeción incorporado

ELGEF® Plus Gomito 45° per elettrosaldatura con fermo incorporato

ELGEF® Plus electrofusion Elbow 90° with integrated holder

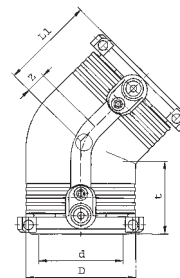

Artikel Nr. N. Articolo Article no	de mm	L 1 mm	D mm	t mm	z mm	GP	Gewicht Peso Weight kg	NPK CAN	Code	Preis Prezzo Price EUR/unid.
S 5/PN 16/SDR 11										
04.7628	32	44	44	36	8	10	0.095	431 132	753 151 608	16.–
04.7629	40	50	54	39	11	10	0.121	431 133	753 151 609	19.10
04.7630	50	56	66	43	13	10	0.156	431 134	753 151 610	25.60
04.7631	63	63	81	48	15	10	0.274	431 135	753 151 611	27.50
dispositivo de sujeción incorporado/senza fermo incorporato/without integrated holder										
04.7700	75	79	97	61	17	10	0.437	431 136	753 151 812	28.80
04.7632	90	85	112	62	23	10	0.652	431 137	753 151 813	48.70
04.7633	110	103	136	71	32	10	1.194	431 138	753 151 814	73.10
04.7634	125	107	151	74	33	5	1.508	431 139	753 151 815	97.50
04.7635	160	134	196	92	42	4	2.215	431 142	753 151 817	189.50
04.8839	180	142	217	95	47	4	3.795	431 143	753 151 818	230.30

ELGEF® Plus «T» 90° para soldadura eléctrica,
Igual, con dispositivo de sujeción incorporado

ELGEF® Plus «T» per elettrosaldatura,
uguale con fermo incorporato

ELGEF® Plus electrofusion Tee 90°, equal
with integrated holder

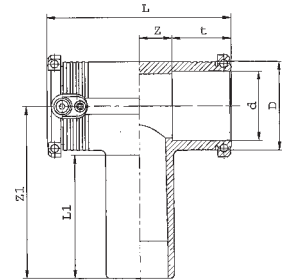

N° art. N. Articolo Article no	de mm	D mm	L mm	L1 mm	t mm	z mm	z1 mm	GP	Peso Peso Weight kg	NPK CAN	Código	Precio Prezzo Price EUR/unid.
S 5/PN 16/SDR 11												
04.8840	20	35	90	67	34	11	92	15	0.100		753 211 606	18.90
04.8841	25	35	90	70	34	11	92	15	0.088		753 211 607	18.90
04.7636	32	44	102	74	36	15	100	8	0.233	431 212	753 211 608	16.40
04.7637	40	54	120	82	39	21	114	10	0.176	431 213	753 211 609	18.90
04.7638	50	66	135	90	43	25	126	5	0.268	431 214	753 211 610	24.-
04.7639	63	81	152	102	48	28	150	5	0.429	431 215	753 211 611	27.30
sin dispositivo de sujeción incorporado/senza fermo incorporato/without integrated holder												
04.7701	75	97	187	78	61	33	126	4	0.597	431 216	753 201 812	28.80
04.7640	90	112	202	84	61	41	146	5	0.994	431 217	753 201 813	45.30
04.7641	110	136	242	88	65	56	161	5	1.688	431 218	753 201 814	71.40
04.7642	125	151	256	92	75	53	174	4	2.315	431 219	753 201 815	92.90
04.7643	160	196	325	103	92	71	206	3	3.207	431 222	753 201 817	181.90
04.8842	180	225	344	110	90	82	250	3	7.607	431 223	753 201 818	275.50

ELGEF® Plus Reducción para soldadura eléctrica,
con dispositivo de sujeción incorporado

ELGEF® Plus Riduzione per elettrosaldatura
con fermo incorporato

ELGEF® Plus electrofusion Reducer
with integrated holder

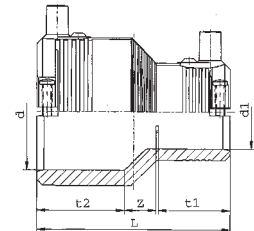

N° art. N. Articolo Article no	d-d1 mm	D mm	L mm	t1 mm	t2 mm	z mm	GP	Peso Peso Weight kg	NPK CAN	Código	Precio Prezzo Price EUR/unid.
S 5/PN 16/SDR 11											
04.8843	25-20	35	74	34	34	6	20	0.059		753 901 639	7.90
04.7216	32-20	44	79	33	36	10	20	0.071		753 901 640	7.90
04.7217	32-25	44	79	33	36	10	20	0.070		753 901 641	7.90
04.7644	40-32	54	88	33	39	13	20	0.085	431 313	753 901 646	9.80
04.7645	50-32	66	96	35	43	18	12	0.109	431 314	753 901 651	13.40
04.7646	50-40	66	96	39	43	14	15	0.136	431 334	753 901 652	13.40
04.7218	63-32	81	106	35	48	23	12	0.191	431 315	753 901 656	13.40
04.7219	63-40	81	106	39	48	19	10	0.196	431 335	753 901 657	13.40
04.7220	63-50	81	106	43	48	15	12	0.209	431 355	753 901 658	13.40
sin dispositivo de sujeción incorporado/senza fermo incorporato/without integrated holder											
04.7647	90-63	112	150	50	64	36	5	0.438	431 377	753 901 831	36.60
04.7648	110-90	136	171	61	71	39	5	0.808	431 438	753 901 833	57.90
04.8844	125-90	152	180	61	79	40	5	0.954	431 836	753 901 836	75.50
04.7649	160-110	196	226	70	91	65	5	1.468	431 462	753 901 834	75.50
04.8845	180-125	220	247	70	97	80	4	2.385	431 835	753 901 835	116.40

ELGEF® Plus Abrazadera de toma para soldadura eléctrica,
Ejecución monoblock

ELGEF® Plus Collare di presa per elettro-
saldatura, esecuzione monoblocco

ELGEF® Plus electrofusion Tapping saddle
monoblock version

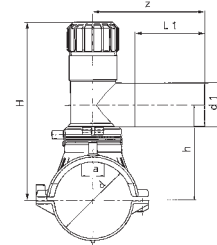

N° art. d-d1 N. Articolo Article no	d-d1 mm	L mm	L 1 mm	h mm	H mm	z mm	Ø perf. Ø a	Peso Peso Weight kg	GP	NPK CAN	Código	Precio Prezzo Price EUR/unid.
04.7678	40-32	103	76	33	99	120	16	0.277	6	464 133	193 131 414	40.80
04.8846	50-32	103	76	38	104	120	16	0.270	5		193 131 424	49.10
04.7679	63-32	126	76	44	134	130	32	0.433	6	464 135	193 131 434	52.90

ELGEF® Plus Abrazaderas de conexión para soldadura eléctrica

ELGEF® Plus Collare di collegamento per elettrosaldatura

ELGEF® Plus electrofusion Saddle

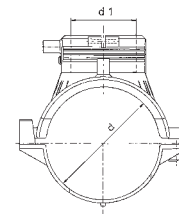

N° art. N. Articolo Article no	d-d1 mm	L mm	GP	Peso Peso Weight kg	NPK CAN	Código	Precio Prezzo Price EUR/unid.
S 5/PN 16/SDR 11							
04.7750	63-63	165	5	0.335	461 235	193 131 037	30.60
04.7751	75-63	165	5	0.465	461 236	193 131 047	27.50
04.7752	90-63	165	5	0.425	461 237	193 131 057	32.60
04.7753	110-63	165	3	0.493	461 238	193 131 067	37.80
04.7754	125-63	165	3	0.523	461 239	193 131 077	51.40
04.7951	140-63	165	3	0.523	461 241	193 131 087	85.50
04.7755	160-63	165	3	0.526	461 242	193 131 097	65.60
04.7756	180-63	165	5	0.632	461 243	193 131 107	85.50
04.7757	200-63	165	5	0.651	461 244	193 131 117	94.60
04.7758	225-63	165	3	0.653	461 245	193 131 127	99.20
04.7952	250-63	165	3	0.665	461 246	193 131 137	120.60
04.8847	280-63*	165	6	0.370	461 247	193 131 147	173.10
04.8848	315-63*	165	6	0.370	461 248	193 131 157	173.10

* no aptas para todos los tipos de abrazaderas de toma «T» «T» con
válvula y tubuladura con perforadora del sistema modular

* non adatto per ogni tipo di «T» di foratura, «T» con
rubinetto e raccordi con perforatrice del sistema modulare

* unsuitable for tapping-tee, tapping salve-tee and
spigot with borer of the modular system

«T» de toma para ELGEF® Plus Abrazaderas simples para soldadura eléctrica 53 131 000

«T» di fortura per ELGEF® Plus Collare semplice per elettrosaldatura 53 131 000

Tapping-tee for ELGEF® Plus electrofusion saddles

Sólo disponible como unidad de embalaje completa (GP)
Fornitura solo in confezione completa (GP)
Only complete packaging units provided (GP)

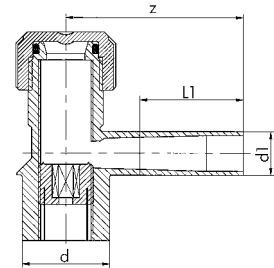

N° art. N. Articolo Article no	d-d1 mm	L1 mm	z mm	GP		Peso Peso Weight kg	Código	Precio Prezzo Price EUR/unid.
04.8849	63-20	69	130	15		0.384	193 280 358	25.70
04.8850	63-25	70	130	15		0.383	193 280 359	25.70
04.7953	63-32	76	130	12		0.383	193 280 184	25.70
04.8851	63-40	81	137	12		0.401	193 280 360	25.70
04.7954	63-63	100	160	12		1.120	193 280 185	35.10

Válvula T para ELGEF® Plus abrazadera de conexión 53 131 022

Ventil-T per ELGEF® Plus Collare per elettrosaldatura 53 131 022

Ventil-T for ELGEF® Plus electrofusion saddles 53 131 022

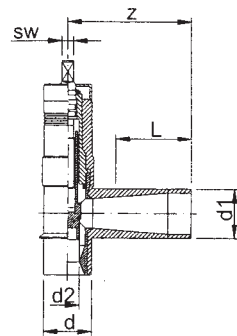

N° art. N. Articolo Article no	d-d1 mm	L1 mm	z mm	GP mm		Peso Peso Weight kg	Código	Precio Prezzo Price EUR/unid.
04.7955	63-63	100	160	33	5	2.405	193 280 410	207.50

Guarnición de extensión rígida/telescópica

Guarnizione per collare di presa con rubinetto

Rigid/Telescope Extension Spindle



N° art. N. Articolo Article no	Cubierta sobre tubos Altezza del riporto sui tubi Pipe Cover	Peso Peso Weight kg	Código	Precio Prezzo Price EUR/unid.
04.8583	0.8 - 1.3 m, ejecución telescópica	1.115	775 010 100	98.40
04.8584	1.4 - 1.8 m, ejecución telescópica	1.576	775 010 101	104.50
04.8585	1.5 m, ejecución rígida	2.448	775 010 102	52.70

Tapón terminal para soldadura eléctrica
con dispositivo de sujeción incorporado

Tappo terminale per elettrosaldatura
con fermo incorporato

Electrofusion cap
with integrated holder

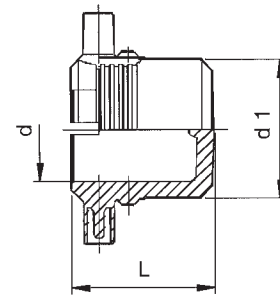

N° art. N. Articolo Article no	d mm	d1 mm	L mm	GP	NPK CAN	Peso Peso Weight kg	Código	Precio Prezzo Price EUR/unid.
04.8830	20	35	52	50		0.045	753 961 606	11.-
04.8831	25	35	52	50		0.037	753 961 607	11.60
04.8832	32	44	52	50	431612	0.087	753 961 608	13.30
04.8833	40	54	56	50	431613	0.081	753 961 609	14.80
04.8834	50	66	60	10	431614	0.102	753 961 610	21.90
04.8835	63	81	66	10	431615	0.170	753 961 611	24.70

Adaptador PE/latón, con rosca macho
para uniones de soldadura eléctrica
ELGEF Plus®

Adattatore PE/ottone, con filettatura esterna
per raccordi elettrosaldatura ELGEF® Plus

Transition PE/brass with male thread
for ELGEF® Plus electrofusion fittings

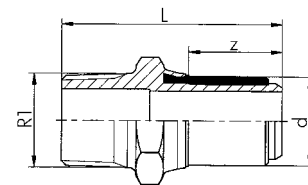

N° art. N. Articolo Article no	d-R1 mm	L mm	z mm	NPK CAN	Peso Peso Weight kg	Código	Precio Prezzo Price EUR/unid.
04.7957	20-1/2"	75	33		0.151	720 920 706	20.50
04.7958	25-3/4"	76	33		0.201	720 920 707	20.50
04.7959	32-1"	80	35	432 532	0.273	720 920 708	20.50
04.8853	32-1 1/4"	82	35		0.389	720 920 718	29.40
04.8854	32-1 1/2"	82	35		0.454	720 920 728	29.40
04.8855	40-1"	84	39		0.370	720 920 719	30.80
04.7960	40-1 1/4"	86	39	432 533	0.425	720 920 709	24.20
04.8856	40-1 1/2"	86	39		0.490	720 920 729	31.10
04.8857	50-1"	88	43		0.479	720 920 720	32.-
04.8858	50-1 1/4"	90	43		0.546	720 920 730	32.-
04.7961	50-1 1/2"	90	43	432 534	0.528	720 920 710	24.20
04.8859	63-1 1/4"	94	47		0.702	720 920 721	41.80
04.8860	63-1 1/2"	94	47		0.698	720 920 731	41.80
04.7962	63-2"	98	47	432 535	0.792	720 920 711	35.60

Adaptador/reductor PE/latón
con rosca macho para uniones de
soldadura eléctrica ELGEF® Plus

Adattatore-riduttore PE/ottone
con filettatura interna
per raccordi elettrosaldatura ELGEF® Plus

Transition PE/brass with female thread
for ELGEF® Plus electrofusion fittings

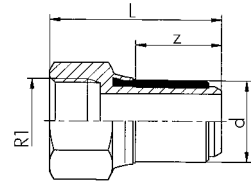

N° art. N. Articolo Article no	d-R 1 mm	L mm	Z mm	GP	NPK CAN	Peso Peso Weight kg	Código	Precio Prezzo Price EUR/unid.
04.7963	32-1"	71	35	-	432 512	0.250	720 920 208	25.60
04.7964	40-1 1/4"	77	39	-	432 513	0.397	720 920 209	29.40
04.7965	50-1 1/2"	81	43	-	432 514	0.589	720 920 210	34.80
04.8861	63-1"	89	47	-		1.071	720 920 221	43.-
04.8862	63-1 1/4"	89	47	-		1.027	720 920 231	43.-
04.8863	63-1 1/2"	89	47	-		0.950	720 920 241	43.-
04.7966	63-2"	89	47	-	432 515	0.800	720 920 211	49.60

Adaptador para tubo PE100 con rosca macho R

Adattatore per tubo PE100 a filettatura esterna R

Transition with male thread/PE 100

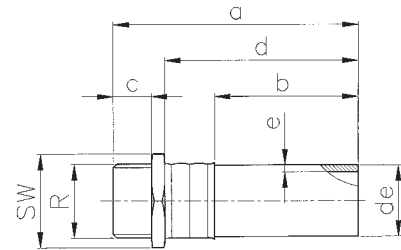

N° art. N. Articolo Article no	de mm	e mm	R AG/ FM	SW mm	a mm	b mm	c mm	d mm		Peso Peso Weight kg	Precio Prezzo Price EUR/unid.
06.5278	32	2.9	1"	42	185	136	17	160		0.200	10.-
06.5279	40	3.7	1 1/4"	59	230	163	17	200		0.350	12.-
06.5280	50	4.0	1 1/2"	52	342	264	24	300		0.595	28.20

Adaptador para tubo PE100 con rosca hembra R

Adattatore per tubo PE100 a filettatura interna R

Transition with female thread/PE
100

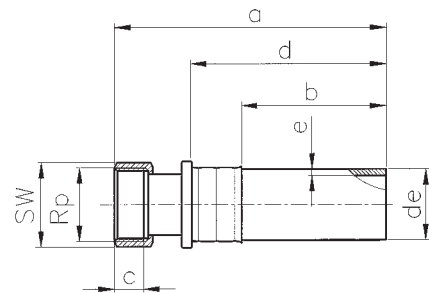

N° art. N. Articolo Article no	de mm	e mm	R IG/ FF	SW mm	a mm	b mm	c mm	d mm		Peso Peso Weight kg	Precio Prezzo Price EUR/unid.
06.5283	32	2.9	1"	38	185	136	17	160		0.200	12.-
06.5284	40	3.7	1 1/4"	47	230	163	17	200		0.350	15.90

Aparatos de soldadura eléctrica

Apparecchiature per elettrosaldatura

MSA Electrofusion control unit



Nº art. N. Articolo Article no	Tipo Type	Descripción Descrizione Feature	Peso Peso Weight kg		Precio Prezzo Price EUR
04.8882	MSA 300	con lector de código de barras/con lettore di codice a barre/Barcode reader	11.500	799 350383	3130.–
04.8883	MSA 350	con lector de código de barras y conexión para impresora/ con lettore codice a barre e collegam pressione/Barcode reader	11.500	799 350 392	3890.–
04.8884	MSA 400	con lector de código de barras y tarjeta de memoria/con lettore codice a barre e scheda memoria/Barcode reader with memory card	11.500	799 350 384	4730.–

Conector adaptador para aparatos de soldadura eléctrica MSA

Spina per adattatore delle apparecchiature MSA

Adapter for electrofusion control unit MSA



Nº art. N. Articolo Article no	d mm	Descripción Descrizione Feature	Peso Peso Weight kg		Precio Prezzo Price EUR
04.6824	4.0	conector angular, par/spina a gomito, paio/angular connector	0.055	799 350 340	60.20
04.6825	4.7	conector angular, par/spina a gomito, paio/angular connector	0.059	799 350 341	65.70

Rasqueta para tubos
para la preparación de tubos PE antes de la soldadura.
Para una ejecución uniforme y rápida, recomendamos usar
la peladora y la rasqueta rotativa.

Raschietto per tubi
per la preparazione dei tubi PE prima della saldatura.
Per un'esecuzione uniforme e rapida consigliamo l'utilizzo
della sfogliatrice e del raschietto rotativo.

Scraper
For the preparation of PE-tubing before the welding.



N° art. N. Articolo Article no	Anchura Larghezza Width mm		Precio Prezzo Price EUR
41.1470	70		17.60
41.1470 A	35		13.80
Cuchilla de recambio, 5 piezas/Lame di ricambio, 5 pezzi/Replacement blade, 5 pieces			
41.1471	70		10.80
41.1471 A	35		8.40

Detergente

Detergente

Cleaning agent

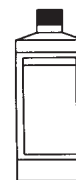

N° art. N. Articolo Article no		Litros Litre	Precio Prezzo Price EUR
04.2170		1.000	16.50

Unión en Y de PE 100 para el
empalme de las sondas geotérmicas

Raccordo a Y in PE 100 GEROtherm® per il
collegamento delle sonde geotermiche

GEROtherm® Headpiece /Y-piece made of PE 100
for geothermal probes

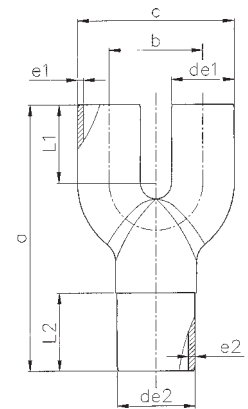

Unidad de embalaje: bolsa de 2 piezas
Unità d'imballo: Busta con 2 pezzi
Packaging unit: Bag with 2 pieces

N° art. N. Articolo Article no	de 1 mm	e1 mm	de2 mm	e2 mm	L1 mm	L2 mm	a mm	b mm	c mm	Peso Peso Weight kg	Precio Prezzo Price EUR/unid.
HS 2 x 32-40 SDR 11/PN 16											
06.1698	32	2.9	40	3.7	35	50	160	50	82	0.110	33.-
HS 2 x 40-50 SDR 11/PN 16											
06.1699	40	3.7	50	4.6	50	50	170	60	100	0.140	33.-

GEROtherm® Unión en Y de PE 100, prolongada

GEROtherm® Raccordo a Y in PE 100, prolungato

GEROtherm® Headpiece/Y-piece made of PE 100, extended
for geothermal probes

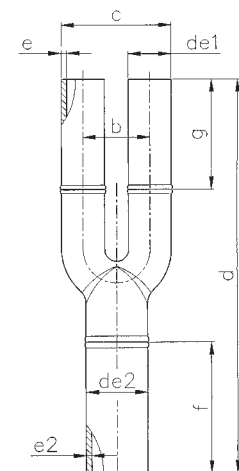

N° art. N. Articolo Article no	de 1 mm	e1 mm	de2 mm	e2 mm	b mm	c mm	d mm	f mm	g mm	Peso Peso Weight kg	Precio Prezzo Price EUR/unid.
HS 2 x 32-40 V SDR 11/PN 16											
06.5270	32	2.9	40	3.7	50	82	660	250	250	0.355	59.-
HS 2 x 40-52 V SDR 11/PN 16											
06.5271	40	3.7	50	4.6	60	100	670	260	250	0.525	59.-

ELGEF® Uniones de tubuladura para soldadura eléctrica
y soldadura a tope – Ángulo 90°

ELGEF® Raccordi a bocchettone per elettro-
saldatura e saldatura di testa – Gomito 90°

ELGEF® Spigot fittings for electrofusion
and butt-welding – Elbow 90°

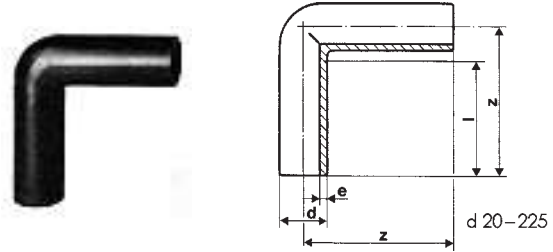

N° art. N. Articolo Article no	de mm	e mm	di mm	l mm	z mm	Peso Peso Weight kg	NPK CAN	Código	Precio Prezzo Price EUR/unid.
S 5/PN 16/SDR 11									
04.7253	20	3	14	52	75	0.032		753 101 006	4.40
04.7254	25	3	19	52	80	0.045		753 101 007	5.40
04.7255	32	3	26	54	85	0.063	422 112	753 101 008	5.40
04.7256	40	3.7	32.6	57	95	0.104	422 113	753 101 009	6.80
04.7257	50	4.6	40.8	63	105	0.169	422 114	753 101 010	9.–
04.7258	63	5.8	51.4	65	115	0.288	422 115	753 101 011	16.–
04.7259	75	6.8	61.2	72	130	0.446	422 116	753 101 012	20.20
04.7260	90	8.2	73.6	81	150	0.737	422 117	753 101 013	26.40
04.7261	110	10	90	86	165	1.162	422 118	753 101 014	47.50
04.7262	125	11.4	103	93	180	1.649	422 119	753 101 015	62.40
04.7998	140	12.7	114.4	110	190	1.919	422 121	753 101 016	83.10
04.7263	160	14.6	130	103	210	3.480	422 122	753 101 017	95.60
04.7264	180	16.4	148	107	232	4.733	422 123	753 101 018	106.–
04.7265	200	18.2	164	117	253	6.460	422 124	753 101 019	154.50
04.7266	225	20.5	183	122	270	8.520	422 125	753 101 020	169.–
04.7267	250	22.7	204	180	307	10.653	422 126	753 101 001	306.–
04.7985	280	25.4	229	200	340	14.282	422 127	753 100 922	466.60
04.7986	315	28.6	257.6	210	370	20.030	422 128	753 100 923	583.–
S 8/PN 10/SDR 17									
04.7987	90	5.4	79.2	81	150	0.593	422 117	753 100 813	23.70
04.7988	110	6.6	96.8	86	165	0.625	422 118	753 100 814	45.20
04.7989	125	7.4	110.2	93	180	0.927	422 119	753 100 815	56.90
04.7990	140	8.3	124	110	190	1.426	422 121	753 100 816	72.50
04.7991	160	9.5	141	102	210	2.830	422 122	753 100 817	83.80
04.7992	180	10.7	158.6	107	232	4.720	422 123	753 100 818	95.60
04.7993	200	11.9	176.2	115	253	5.060	422 124	753 100 819	128.80
04.7994	225	13.4	198.2	120	270	6.190	422 125	753 100 820	152.50
04.7995	250	14.2	221.6	180	307	7.632	422 126	753 100 821	286.40
04.7996	280	15.9	248.2	200	340	10.076	422 127	753 100 822	421.30
04.7997	315	17.9	279.2	210	370	14.068	422 128	753 100 823	524.30

ELGEF® Uniones de tubos para soldadura eléctrica y soldadura a tope – Ángulo 45°

ELGEF® Raccordi a bocchettone per elettrosaldatura e saldatura di testa – Gomito 45°

ELGEF® Spigot fittings for electrofusion and butt-welding – Elbow 45°

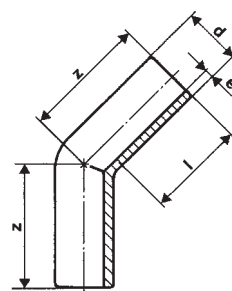

N° art. N. Articolo Article no	de mm	e mm	di mm	l mm	z mm	Peso Peso Weight kg	NPK CAN	Código	Precio Prezzo Price EUR/unid.
S 5/PN 16/SDR 11									
04.7268	32	3	26	54	80	0.061	422 152	753 151 008	6.30
04.7269	40	3.7	32.6	57	85	0.093	422 153	753 151 009	7.60
04.7270	50	4.6	40.8	63	90	0.151	422 154	753 151 010	9.–
04.7271	63	5.8	51.4	65	95	0.250	422 155	753 151 011	16.–
04.7272	75	6.8	61.2	72	105	0.396	422 156	753 151 012	20.20
04.7273	90	8.2	73.6	81	120	0.623	422 157	753 151 013	26.40
04.7274	110	10	90	86	130	0.989	422 158	753 151 014	47.50
04.7275	125	11.4	103	92	140	1.395	422 159	753 151 015	62.40
04.8400	140	12.7	114.4	100	135	1.594	422 161	753 151 016	83.10
04.7276	160	14.6	130	102	160	2.738	422 162	753 151 017	95.60
04.7277	180	16.4	148	107	170	3.657	422 163	753 151 018	106.10
04.7278	200	18.2	164	117	185	4.990	422 164	753 151 019	155.60
04.7279	225	20.5	183	122	200	7.150	422 165	753 151 020	169.–
04.7280	250	22.7	204	155	217	7.633	422 166	753 151 021	306.–
04.8401	280	25.5	229	168.5	238	10.450	422 167	753 150 922	466.60
04.8402	315	28.6	257.6	177	256	13.900	422 168	753 150 923	583.–
S 8/PN 10/SDR 17									
04.8403	90	5.4	79.2	81	120	0.495	422 157	753 150 813	23.70
04.8404	110	6.6	96.8	86	132	0.775	422 158	753 150 814	45.20
04.8405	125	7.4	110.2	92	140	1.085	422 159	753 150 815	57.10
04.8406	140	8.3	124	100	135	1.071	422 161	753 150 816	72.50
04.8407	160	9.5	141	102	162	2.128	422 162	753 150 817	83.80
04.8408	180	10.7	158.6	107	173	2.755	422 163	753 150 818	95.60
04.8409	200	11.9	176.2	115	185	3.810	422 164	753 150 819	128.80
04.8410	225	13.4	198.2	122	205	5.780	422 165	753 150 820	152.50
04.8411	250	14.2	221.6	155	217	5.031	422 166	753 150 821	286.40
04.8412	280	15.9	248.2	162	232	6.933	422 167	753 150 822	421.30
04.8413	315	17.9	279.2	173	251	9.950	422 168	753 150 823	524.30

ELGEF® Uniones de tubos para soldadura eléctrica y soldadura a tope – Ángulo 30°

ELGEF® Raccordi a bocchettone per elettrosaldatura e saldatura di testa – Gomito 30°

ELGEF® Spigot fittings for electrofusion and butt-welding – Elbow 30°

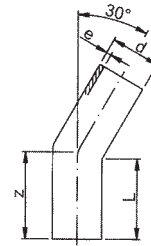

N° art. N. Articolo Article no	de mm	e mm	L mm	z mm	Peso Peso Weight kg	NPK CAN	Código	Precio Prezzo Price EUR/unid.
S 5/PN 16/SDR 11								
04.8640	75	6.8	76	108	0.570	422 176	753 120 912	54.50
04.8641	90	8.2	193.5	208.5	0.540	422 177	753 120 913	60.70
04.8642	110	10.0	197.5	216.5	1.500	422 178	753 120 914	76.40
04.8643	125	11.4	100	132	1.240	422 179	753 120 915	83.10
04.8644	140	12.8	115	147	1.760	422 181	753 120 916	102.30
04.8645	160	14.6	205.5	231.5	3.425	422 182	753 120 917	161.80
S 8/PN 17/SDR 17.6								
04.8650	75	4.3	76	108	0.340		753 120 812	46.80
04.8651	90	5.1	76	105	0.430		753 120 813	48.40
04.8652	110	6.3	197.5	216.5	1.500		753 120 814	72.50
04.8653	125	7.1	100	132	1.070		753 120 815	76.40
04.8654	140	8.0	115	147	1.490		753 120 816	86.10
04.8655	160	9.1	205.5	131.5	3.000		753 120 817	157.60

Ángulo 90°
Gomito 90°
Elbow 90°

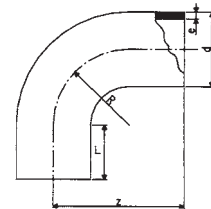

N° art. N. Articolo Article no	de mm	e mm	L mm	R mm	z mm	Peso Peso Weight kg	NPK CAN	Código	Precio Prezzo Price EUR/unid.
S 5/PN 16/SDR 11									
04.8660	20	3	55	45	100	0.020		753 001 006	7.20
04.8661	25	3	60	52	112	0.030		753 001 007	7.50
04.8662	32	3	70	65	135	0.050	421 112	753 001 008	8.20
04.8663	40	3.7	80	86	156	0.090	421 113	753 001 009	10.50
04.8664	50	4.6	85	85	165	0.160	421 114	753 001 010	14.50
04.8665	63	5.8	90	93	183	0.290	421 115	753 001 011	24.30
04.8666	75	6.8	105	98	203	0.300	421 116	753 001 012	27.60
04.8667	90	8.2	110	105	215	0.530	421 117	753 001 013	35.50
04.8668	110	10	130	112	238	0.890	421 118	753 001 014	56.–
04.8669	125	11.4	135	127	262	1.290	421 119	753 001 015	83.10
04.8670	160	14.6	155	166	315	2.460	421 122	753 001 017	135.–
04.8671	200	18.2	170	208	378	4.480	421 124	753 001 019	178.20
04.8672	225	20.5	178	230	408	5.850	421 125	753 001 020	217.40
04.8673	250	22.7	195	255	440	9.230	421 126	753 001 021	394.50
04.8674	280	25.4	175	285	490	17.410	421 127	753 001 022	409.–
04.8675	315	28.6	205	317	545	23.950	421 128	753 001 023	563.50

ELGEF® «T» 90°, igual
ELGEF® «T» 90°, uguale
ELGEF® Tee 90°, equal

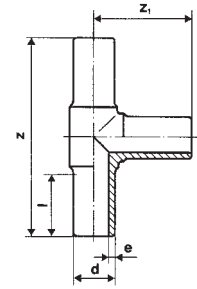

N° art. N. Articolo Article no	de mm	e mm	di mm	l mm	z mm	z1 mm	Peso Peso Weight kg	NPK CAN	Código	Precio Prezzo Price EUR/unid.
S 5/PN 16/SDR 11										
04.7281	20	3	14	52	150	75	0.060		753 201 006	4.90
04.7282	25	3	19	52	160	80	0.075		753 201 007	5.80
04.7283	32	3	26	54	170	85	0.095	423 112	753 201 008	7.-
04.7284	40	3.7	32.6	57	190	95	0.151	423 113	753 201 009	8.70
04.7285	50	4.6	40.8	63	210	105	0.241	423 114	753 201 010	11.-
04.7286	63	5.8	51.4	65	230	115	0.407	423 115	753 201 011	14.80
04.7287	75	6.9	61.2	72	264	132	0.681	423 116	753 201 012	24.70
04.7288	90	8.2	73.6	81	300	150	1.069	423 117	753 201 013	34.70
04.7289	110	10	90	86	330	165	1.765	423 118	753 201 014	53.80
04.7290	125	11.4	102.2	92	366	183	2.521	423 119	753 201 015	74.-
04.8414	140	12.8	114.4	98	380	190	3.356	423 121	753 201 016	125.70
04.7291	160	14.6	130.8	102	420	210	4.747	423 122	753 201 017	140.10
04.7292	180	16.4	147.2	107	460	230	6.365	423 123	753 201 018	190.60
04.7293	200	18.2	163.6	117	500	250	8.590	423 124	753 201 019	265.80
04.7294	225	20.5	184	122	540	270	11.825	423 125	753 201 020	315.20
04.7295	250	22.7	204	148	622	310	16.805	423 126	753 201 001	422.30
04.8415	280	25.5	229	160	694	347	24.960	423 127	753 200 902	658.20
04.8416	315	28.7	257.6	170	752	375	32.120	423 128	753 200 903	809.60
S 8/PN 10/SDR 17										
04.8417	90	5.4	79.2	80	300	150	0.853	423 117	753 200 813	33.30
04.8418	110	6.6	96.8	86	330	165	1.405	423 118	753 200 814	49.20
04.8419	125	7.4	110.2	92	370	185	1.951	423 119	753 200 815	67.-
04.8420	140	8.3	123.4	98	380	190	2.555	423 121	753 200 816	110.30
04.8421	160	9.5	141	104	428	214	3.708	423 122	753 200 817	125.70
04.8422	180	10.7	158.6	107	460	230	4.872	423 123	753 200 818	172.10
04.8423	200	11.9	176.2	115	500	250	6.740	423 124	753 200 819	238.-
04.8424	225	13.4	198.2	122	540	270	9.140	423 125	753 200 820	283.30
04.8425	250	14.2	221.6	148	624	314	12.443	423 126	753 200 821	401.70
04.8426	280	15.9	248.2	160	694	347	16.081	423 127	753 200 802	576.80
04.8427	315	17.9	279.2	170	760	380	22.823	423 128	753 200 803	744.70

ELGEF® «T» 90°, reducido
ELGEF® «T» 90°, ridotto
ELGEF® Tee 90°, reduced

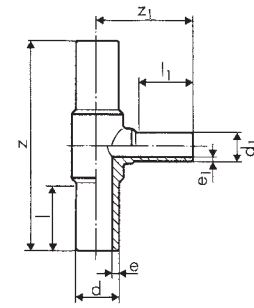

N° art. N. Articolo Article no	d-d1 mm	e mm	e 1 mm	l mm	l 1 mm	z mm	z1 mm	Peso Peso Weight kg	NPK CAN	Código	Precio Prezzo Price EUR/unid.
S 5/PN 16/SDR 11											
04.3353	63x50	5.8	4.6	63	56	215	103	0.349		753 201 044	18.-
04.3354	75x32	6.8	3.0	70	46	256	108	0.539		753 201 045	25.10
04.3355	75x50	6.8	4.6	70	56	255	108	0.579		753 201 046	25.10
04.3356	75x63	6.8	5.8	70	63	255	117	0.609		753 201 047	25.10
04.3357	90x63	8.2	5.8	79	64	269	136	0.887		753 201 029	34.70
04.7296	90x75	8.2	6.9	73	70	272	138	0.905	423 257	753 201 030	34.70
04.3358	110x63	10	5.8	84	65	309	156	1.436		753 201 028	50.70
04.7297	110x75	10	6.9	82	70	309	151	1.413	423 258	753 201 031	50.70
04.3359	110x90	10	8.2	82	79	310	152	1.444		753 201 032	50.70
04.3360	125x90	11.4	8.2	110	91	335	170	1.885		753 201 048	74.20
04.3361	125x110	11.4	10	89.5	83	340.5	169.5	2.023		753 201 033	74.-
04.3362	160x63	14.6	5.8	98	65	340	175.5	2.925		753 201 034	143.20
04.7299	160x75	14.6	6.9	98	74	340	179.5	2.971	423 262	753 201 035	142.20
04.7300	160x90	14.6	8.2	98	79	340	179.5	3.020	423 282	753 201 036	142.20
04.7301	160x110	14.6	10	98	83	390.5	201.5	3.725	423 322	753 201 037	142.20
04.3363	180x90	16.4	8.2	136	98	420	202	4.950		753 201 049	192.70
04.3364	180x110	16.4	10	131	100	430	205	4.379		753 201 050	192.70
04.7302	180x160	16.4	14.6	101.5	93.5	411	204.5	5.229	423 383	753 201 038	192.70
04.3365	225x75	20.5	6.8	118.5	75	441	226.5	7.350		753 201 039	324.50
04.7303	225x90	20.5	8.2	118.5	79	441	224.5	7.483	423 285	753 201 040	324.50
04.7304	225x110	20.5	10	117.5	83	441	236.5	7.450	423 325	753 201 041	324.50
04.7305	225x160	20.5	14.6	120	106	488	246.5	8.945	423 385	753 201 042	324.50
04.7306	225x180	20.5	16.6	131.5	131.5	543	276.5	10.225	423 425	753 201 043	324.50
S 8/PN 10/SDR 17											
04.3366	90x63	5.4	3.8	79	63	269	135	0.560		753 200 829	30.80
04.8428	90x75	5.4	4.5	74	70	274	137	0.593	423 257	753 200 830	30.80
04.3367	110x63	6.6	3.8	83	64	310	156	1.069		753 200 828	45.20
04.8429	110x75	6.6	4.5	82	70	310	155	1.051	423 258	753 200 831	45.20
04.3368	110x90	6.6	5.4	82	79	310	157	1.109		753 200 832	45.20
04.8430	125x110	7.4	6.6	87.5	82	334.5	169.5	1.619	423 319	753 200 833	65.40
04.3369	160x63	9.5	3.8	98	64	340	174.5	2.195		753 200 834	127.80
04.8431	160x75	9.5	4.5	98	75	340	181.5	2.205	423 262	753 200 835	127.80
04.8432	160x90	9.5	5.4	98	81	340	180	2.217	423 282	753 200 836	127.80
04.8433	160x110	9.5	6.6	98	83	392.5	191	2.839	423 322	753 200 837	129.80
04.3370	180x90	10.7	5.4	134	97	394	200	3.708		753 200 844	125.70
04.8434	180x160	10.7	9.5	101.5	91.5	412	206.5	4.068	423 383	753 200 838	125.70
04.3371	225x75	13.4	4.5	120	80	445	227	5.450		753 200 839	297.70
04.8435	225x90	13.4	5.4	120	80	445	227	5.582	423 285	753 200 840	297.70
04.8436	225x110	13.4	6.6	119	86	445	227	5.550	423 325	753 200 841	297.70
04.8437	225x160	13.4	9.5	119	98	488	244	6.772	423 385	753 200 842	297.70
04.8438	225x180	13.4	10.7	131.5	134.5	553	283.5	7.211	423 425	753 200 843	297.70

ELGEF® Tapón
ELGEF® Tappo
ELGEF® Spigot cap

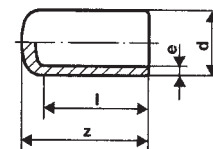

N° art. N. Articolo Article no	de mm	e mm	di mm	l mm	z mm	Peso Peso Weight kg	NPK CAN	Código	Precio Prezzo Price EUR/unid.
S 5/PN 16/SDR 11									
04.7307	20	3	14	52	52	0.013		753 961 006	4.10
04.7308	25	3	19	52	52	0.017		753 961 007	4.30
04.7309	32	3	26	54	54	0.022	425 112	753 961 008	5.60
04.7310	40	3.7	32.6	57	57	0.035	425 113	753 961 009	6.20
04.7311	50	4.6	40.8	63	63	0.060	425 114	753 961 010	8.50
04.7312	63	5.8	51.4	65	65	0.095	425 115	753 961 011	11.70
04.7313	75	6.9	61.2	72	79	0.167	425 116	753 961 012	17.–
04.7314	90	8.2	73.6	81	90	0.257	425 117	753 961 013	27.20
04.7315	110	10	90	86	98	0.434	425 118	753 961 014	37.–
04.7316	125	11.4	102.2	92	105	0.596	425 119	753 961 015	39.80
04.8439	140	12.8	114.4	106	144	0.897	425 121	753 961 016	48.40
04.7317	160	14.6	130.8	102	120	1.091	425 122	753 961 017	56.90
04.7318	180	16.4	147.2	107	128	1.460	425 123	753 961 018	68.50
04.7319	200	18.2	163.6	115	138	1.944	425 124	753 961 019	90.50
04.7320	225	20.5	184	122	148	2.605	425 125	753 961 020	106.10
04.7321	250	22.8	204.4	152	230	4.172	425 126	753 961 021	155.60
04.8440	280	25.5	229	162	257	5.834	425 127	753 960 922	218.40
04.8441	315	28.7	257.6	167	262	7.751	425 128	753 960 923	293.60
S 8/PN 10/SDR 17									
04.8442	90	5.2	79.2	81	90	0.240	425 117	753 960 813	27.20
04.8443	110	6.3	96.8	86	98	0.400	425 118	753 960 814	37.20
04.8444	125	7.1	110.2	92	105	0.596	425 119	753 960 815	41.40
04.8445	140	8.3	123.4	106	144	0.585	425 121	753 960 816	48.40
04.8446	160	9.1	141	102	120	1.055	425 122	753 960 817	56.90
04.8447	180	10.3	158.6	107	128	1.445	425 123	753 960 818	68.50
04.8448	200	11.4	176.2	115	138	1.985	425 124	753 960 819	90.50
04.8449	225	12.8	198.2	122	148	2.605	425 125	753 960 820	106.10
04.8450	250	14.2	221.6	152	230	2.792	425 126	753 960 821	139.10
04.8451	280	15.9	248.2	162	257	4.013	425 127	753 960 822	201.90
04.8452	315	17.9	279.2	167	262	5.333	425 128	753 960 823	264.80

ELGEF® Reducción
ELGEF® Riduzione
ELGEF® Reduction

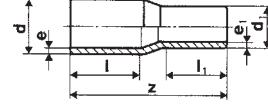

N° art. N. Articolo Article no	d-d1 mm	e mm	3 1 mm	l mm	l1 mm	z mm	Peso Peso Weight kg	NPK CAN	Código	Precio Prezzo Price EUR/unid.
S 5/PN 16/SDR 11										
04.3372	25x20	3	3	54	52	120	0.022		753 901 038	3.40
04.7322	32x20	3	3	54	52	120	0.023		753 901 042	3.40
04.7323	32x25	3.7	3	57	52	130	0.025		753 901 041	3.90
04.7324	40x20	3.7	3	57	52	130	0.048		753 901 048	5.20
04.7325	40x25	3.7	3	57	52	130	0.051		753 901 047	5.20
04.7326	40x32	3.7	3	57	53	130	0.057	424 133	753 901 046	5.20
04.3373	50x20	4.6	3	63	52	150	0.050		753 901 055	6.20
04.7327	50x25	4.6	3	63	52	140	0.074		753 901 054	6.20
04.7328	50x32	4.6	3	63	53	140	0.077	424 134	753 901 053	6.20
04.7329	50x40	4.6	3.7	63	57	140	0.089	424 154	753 901 052	6.20
04.7330	63x32	5.8	3	65	53	150	0.120	424 135	753 901 060	8.50
04.7331	63x40	5.8	3.7	65	57	150	0.125	424 155	753 901 059	8.50
04.7332	63x50	5.8	4.6	65	63	150	0.144	424 175	753 901 058	8.50
04.3374	75x40	6.8	3.7	72	57	170	0.197	424 156	753 901 063	13.-
04.7333	75x50	6.9	4.6	72	63	170	0.207	424 176	753 901 064	13.-
04.7334	75x63	6.9	5.8	72	65	170	0.242	424 216	753 901 065	13.-
04.3375	90x50	8.2	4.6	81	63	190	0.324	424 177	753 901 072	18.30
04.7335	90x63	8.2	5.8	81	65	190	0.350	424 217	753 901 071	18.30
04.7336	90x75	8.2	6.9	81	70	190	0.385	424 237	753 901 070	18.30
04.7337	110x63	10	5.8	86	65	205	0.522	424 218	753 901 078	24.-
04.3376	110x75	10	6.8	86	70	205	0.563	424 238	753 901 077	24.-
04.7338	110x90	10	8.2	86	81	205	0.603	424 258	753 901 076	24.-
04.7339	125x63	11.4	5.8	87	61	187	0.635	424 219	753 901 083	29.30
04.3377	125x75	11.4	6.8	92	72	215	0.703	424 239	753 901 082	29.30
04.7340	125x90	11.4	8.2	92	81	215	0.752	424 259	753 901 081	29.30
04.7341	125x110	11.4	10	92	86	215	0.863	424 279	753 901 080	29.30
04.8454	140x125	12.8	11.4	96.5	90	211	1.147	424 321	753 901 085	44.40
04.7342	160x90	14.6	8.2	102	74	217	1.219	424 262	753 901 088	56.90
04.7343	160x110	14.6	10	102	86	245	1.448	424 282	753 901 090	56.90
04.7344	160x125	14.6	11.4	102	92	245	1.547	424 322	753 901 089	56.90
04.3378	160x140	14.6	12.7	101.5	96.5	229	1.350	424 342	753 901 032	60.50
04.7345	180x125	16.4	11.4	107	92	255	1.815	424 323	753 901 091	74.-
04.3379	180x160	16.4	14.6	107	102	255	2.435	424 363	753 901 033	75.70
04.7346	200x160	18.2	14.6	117	102	265	3.285	424 364	753 901 092	77.20
04.3380	200x180	18.2	16.4	117	107	265	2.580	424 384	753 901 093	77.20
04.7347	225x160	20.5	14.6	112	102	280	4.320	424 365	753 901 096	129.-
04.3381	225x180	20.5	16.4	122	107	280	3.920	424 385	753 901 095	129.-
04.3382	225x200	20.5	18.2	122	117	280	3.750	424 425	753 901 094	129.-
04.3383	250x160	22.7	14.6	155	113	314	2.875	424 366	753 901 000	163.80
04.3384	250x200	22.7	18.2	155	125	314	2.875	424 426	753 901 001	172.10
04.3385	250x225	22.7	20.5	153	133	315	2.875	424 446	753 901 002	172.10
04.3386	280x250	25.4	22.7	165	155	355	2.385	424 467	753 901 003	187.50

ELGEF® Reducción
ELGEF® Riduzione
ELGEF® Reduction

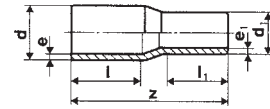

N° art. N. Articolo Article no	d-d1 mm	e mm	e 1 mm	l mm	l 1 mm	z mm	Peso Peso Weight kg	NPK CAN	Código	Precio Prezzo Price EUR/unid.
S 5/PN 16/SDR 11										
04.3387	315x200	28.6	18.2	180	134	380	2.385	424 428	753 901 004	203.-
04.3388	315x225	28.6	20.5	168	125	375	7.790	424 448	753 901 097	203.-
04.3389	315x250	28.6	22.7	174	155	375	2.385	424 468	753 901 005	203.-
S 8/PN 10/SDR 17										
04.8455	90x63	5.4	3.8	71	63	159	0.244	424 217	753 900 871	18.30
04.8456	90x75	5.4	4.5	74	65	163	0.202	424 237	753 900 870	18.30
04.8457	110x63	6.6	3.8	83	58	179	0.368	424 218	753 900 878	24.-
04.8458	110x90	6.6	5.4	85	80	205	0.451	424 258	753 900 876	24.-
04.8459	125x63	11.4	5.8	87	61	187	0.465	424 219	753 900 883	29.30
04.8460	125x90	7.4	5.4	90	80	215	0.752	424 259	753 900 881	29.30
04.8461	125x110	7.4	6.6	90	85	215	0.863	424 279	753 900 880	29.30
04.8463	140x125	8.3	7.4	98.5	91.5	213.5	0.871	424 321	753 900 885	44.40
04.8464	160x90	9.5	5.4	104.5	79	222.5	0.911	424 262	753 900 888	57.-
04.8465	160x110	9.5	6.6	100	85	245	0.987	424 282	753 900 890	57.-
04.8466	160x125	9.5	7.4	100	90	245	1.024	424 322	753 900 889	57.-
04.3390	160x140	9.5	8.3	99.5	95.5	231	1.000		753 900 831	61.60
04.8467	180x125	10.7	7.4	105	90	255	1.815	424 323	753 900 891	74.20
04.3391	180x160	10.7	9.5	105	100	255	1.400		753 900 832	75.-
04.8468	200x160	11.9	9.5	115	100	265	2.225	424 364	753 900 892	77.20
04.3392	200x180	11.9	10.7	115	105	265	2.025		753 900 893	77.20
04.8469	225x160	13.4	9.5	120	100	280	4.320	424 365	753 900 896	129.80
04.3393	225x180	13.4	10.7	120	105	280	3.160		753 900 895	129.80
04.3394	225x200	13.4	11.9	120	115	280	3.750		753 900 894	129.80
04.3395	250x160	14.8	9.5	112	99.5	253	2.385		753 900 800	163.80
04.3396	250x200	14.8	11.9	154	125	317	2.385		753 900 801	172.10
04.3397	250x225	14.8	13.4	152	133	312	2.385		753 900 802	172.10
04.3398	280x250	16.6	14.8	162	157.5	355	2.385		753 900 803	175.10
04.3399	315x200	18.7	11.9	180	134	380	2.385		753 900 804	195.70
04.3400	315x225	18.7	13.4	170	135	380	1.900		753 900 807	195.70
04.3401	315x250	18.7	14.8	168	153	376	2.385		753 900 805	195.70

ELGEF® Abrazadera de presoldadura,
junta plana
Contrapieza: plana o ranurada
Superficie de junta: ranurada

ELGEF® Collare di presaldatura, guarnizione piatta
Femmina: piatta o rigata
Superficie di tenuta: rigata

ELGEF® Flange adapter
gasket (sealing surface fluted,
analogue flator fluted)

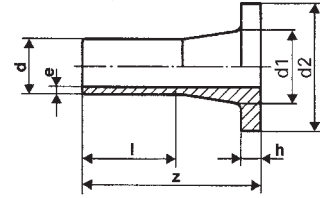

N° art. N. Articolo Article no	de mm	e mm	h mm	l mm	d1 mm	d2 mm	z mm	Peso Peso Weight kg	NPK CAN	Código	Precio Prezzo Price EUR/unid.
S 5/PN 16/SDR 11											
04.7348	32	3	10	54	42	68	80	0.070	425 312	753 801 008	5.10
04.7349	40	3.7	11	57	51	78	85	0.103	425 313	753 801 009	6.–
04.7350	50	4.6	12	63	61	88	92	0.144	425 314	753 801 010	7.20
04.7351	63	5.8	14	69	75	102	100	0.211	425 315	753 801 011	8.50
04.7352	75	6.8	16	87	89	122	120	0.426	425 316	753 801 012	11.20
04.7353	90	8.2	17	101	106	138	140	0.584	425 317	753 801 013	15.50
04.7354	110	10	18	120	126	158	160	0.972	425 318	753 801 014	19.80
04.7355	125	11.4	25	123	132	158	170	0.996	425 319	753 801 015	24.–
04.8470	140	12.7	25	30	155	188	80	1.442	425 321	753 801 016	30.80
04.7356	160	14.6	25	133	176	212	180	1.779	425 322	753 801 017	33.60
04.7357	180	16.4	30	160	180	212	190	2.292	425 323	753 801 018	51.40
04.7358	200	18.2	32	132	234	268	200	3.835	425 324	753 801 019	62.40
04.7359	225	20.5	32	138	235	268	200	2.402	425 325	753 801 020	67.–
04.7360	250	22.7	35	58	285	320	130	6.392	425 326	753 801 001	100.20
04.8471	280	25.4	35	70	291	320	130	9.293	425 327	753 800 902	150.40
04.8472	315	28.6	35	65	335	370	138	12.811	425 328	753 800 903	189.60
S 8/PN 10/SDR 17											
04.8473	90	5.4	17	101	106	138	140	0.584	425 317	753 800 813	15.50
04.8474	110	6.6	18	120	126	158	160	0.972	425 318	753 800 814	19.80
04.8475	125	7.4	25	123	132	158	170	0.711	425 319	753 800 815	24.–
04.8476	140	8.0	18	32	155	188	80	1.089	425 321	753 800 816	30.80
04.8477	160	9.5	25	133	176	212	180	1.281	425 322	753 800 817	33.60
04.8478	180	10.7	30	160	180	212	190	1.749	425 323	753 800 818	51.40
04.8479	200	11.9	32	133	234	268	200	3.835	425 324	753 800 819	62.40
04.8480	225	13.4	32	138	235	268	200	3.365	425 325	753 800 820	67.–
04.8481	250	14.2	25	60	285	320	130	4.621	425 326	753 800 821	90.50
04.8482	280	15.9	25	70	291	320	130	6.410	425 327	753 800 802	136.–
04.8483	315	17.9	25	73	335	370	138	9.187	425 328	753 800 803	175.10

Junta de brida

- Juntas de perfil G-ST, hasta 16 bar
- para abrazadera de presoldadura n° 53 80 10
- Superficie de junta: ranurada o lisa
- para agua potable y gas

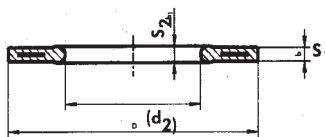

Guarnizione per flangia

- Profilati a tenuta G-ST, fino a 16 bar
- per collare presaldatura n. 53 80 10
- Superficie di tenuta rigata/piatta
- per acqua potabile e gas

Gasket

- profile packing, applicable up to 16 bar
- suitable for flange adapter no. 53 80 10
- sealing surface flat or flated
- applicable for gas and drinking water

N° art. N. Articolo Article no	d	DN	Dimensiones d1 x d2 x s1/s2	Apta para espesor de pared SDR	Peso Peso Weight kg	Código	Precio Prezzo Price EUR
04.8600	25		24 x 61 x 3/4	17	0.010	745 440 202	5.40
04.8601	25		22 x 61 x 3/4	11/7.4	0.012	745 440 302	5.40
04.8602	32		30 x 71 x 3/4	17	0.015	745 440 203	5.60
04.8603	32		28 x 71 x 3/4	11/7.4	0.016	745 440 303	5.70
04.8604	40		37 x 82 x 3/4	17	0.024	745 440 204	5.80
04.8605	40		34 x 82 x 3/4	11/7.4	0.025	745 440 304	5.90
04.8606	50		46 x 92 x 3/4	17	0.031	745 440 205	6.-
04.8607	50		42 x 92 x 3/4	11/7.4	0.033	745 440 305	6.10
04.8608	63	50	58 x 107 x 4/5	17	0.047	745 440 206	6.20
04.8609	63	50	53 x 107 x 4/5	11/7.4	0.048	745 440 306	6.40
04.8610	75	65	69 x 127 x 4/5	17	0.057	745 440 207	6.30
04.8611	75	65	63 x 127 x 4/5	11/7.4	0.059	745 440 307	6.40
04.8612	90	80	84 x 142 x 4/5	17	0.075	745 440 208	6.60
04.8613	90	80	76 x 142 x 4/5	11/7.4	0.076	745 440 308	6.80
04.8614	110	100	100 x 162 x 5/6	17	0.117	745 440 209	7.60
04.8615	110	100	93 x 162 x 5/6	11/7.4	0.124	745 440 309	7.70
04.8616	125	100	114 x 162 x 5/6	17	0.080	745 440 210	8.60
04.8617	125	100	105 x 162 x 5/6	11/7.4	0.110	745 440 310	8.70
04.8618	140	125	127 x 192 x 5/6	17	0.118	745 440 211	8.30
04.8619	140	125	117 x 192 x 5/6	11/7.4	0.146	745 440 311	8.40
04.8620	160	150	146 x 218 x 6/8	17	0.240	745 440 212	10.10
04.8621	160	150	135 x 218 x 6/8	11/7.6	0.207	745 440 312	10.40
04.8622	180	150	164 x 218 x 6/8	17	0.160	745 440 213	9.80
04.8623	180	150	151 x 218 x 6/8	11/7.6	0.236	745 440 313	10.-
04.8624	200	200	181 x 273 x 6/8	17	0.406	745 440 214	13.40
04.8625	200	200	168 x 273 x 6/8	11/7.4	0.430	745 440 314	13.30
04.8626	225	200	203 x 273 x 6/8	17	0.316	745 440 215	13.80
04.8627	225	200	188 x 273 x 6/8	11/7.4	0.365	745 440 315	13.50
04.8628	250	250	226 x 328 x 6/8	17	0.510	745 440 216	16.70
04.8629	250	250	208 x 328 x 6/8	11/7.4	0.520	745 440 316	17.50
04.8630	280	250	252 x 328 x 6/8	17	0.400	745 440 217	17.80
04.8631	280	250	233 x 328 x 6/8	11/7.4	0.496	745 440 317	18.50
04.8632	315	300	283 x 378 x 6/8	17	0.850	745 440 218	21.30
04.8633	315	300	262 x 378 x 6/8	11/7.4	0.600	745 440 318	22.10
04.8634	355	300	319 x 435 x 6/8	17	0.760	745 440 219	32.20
04.8635	355	300	294 x 438 x 6/8	11/7.4	1.100	745 440 319	32.80
04.8636	400	400	359 x 489 x 6/8	17	0.840	745 440 220	39.10
04.8637	400	400	331 x 489 x 6/8	11/7.4	1.300	745 440 320	39.90

IPP DELTAFLEX® Brida PPDA

PPDA – brida métrica

Dimensiones ISO/DIN para soldadura a tope

Brida libre, polipropileno con pieza insertada de fundición (GGG 40)

Material: polipropileno (reforzado con 30 % de fibra de vidrio),
Pieza insertada de fundición esférica GGG 40

Dimensiones: ISDO/DIN 2501 PN 10 (diámetro interno PN 10)

Factor de seguridad: 2,0 (todas las dimensiones)

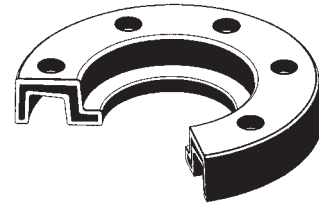

PPDA – Flangia metrica

Dimensioni ISO/DIN per saldatura di testa

Flangia libera, polipropilene con inserto in acciaio (GGG 40)

Materiale: Polipropilene (rinforzato con 30 % fibra di vetro),
Inserto in ghisa sferoidale GGG 40

Dimensioni: ISDO/DIN 2501 PN 10 (diametro interno PN 10)

Fattore di sicurezza: 2,0 (tutte le dimensioni)

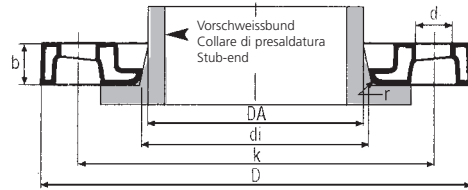

PPDA – Metric Flanges ISO/DIN

Backup Rings, Polypropylene Encapsulated Ductile Iron (GGG 40)

Material: Polypropylene (30% fiberglass reinforced),
insert made from ductile iron GGG 40

Drilling: ISO/DIN 2501 PN 10 (bolt hole circle PN 10)

Safety Factor: 2,0 (all diameters)

N° art. N. Articolo Article no	DA mm	DN	bar	di mm	D mm	k mm	b mm	d mm	n	M mm	r		Peso Peso Weight kg	Precio Prezzo Price EUR
04.5070	20	15	16	28	106	65	18	14	4	M12	3		0.400	8.30
04.5071	25	20	16	34	118	75	18	14	4	M12	3		0.500	9.20
04.5000	32	25	16	42	122	85	17	14	4	M12	3		0.500	9.60
04.5001	40	32	16	51	142	100	17	18	4	M16	3		0.600	11.40
04.5002	50	40	16	62	156	110	19	18	4	M16	3		0.800	13.60
04.5003	63	50	16	78	171	125	20	18	4	M16	3		0.900	17.20
04.5004	75	65	16	92	191	145	21	18	4	M16	3		1.200	19.10
04.5005	90	80	16	108	206	160	21	18	8	M16	3		1.200	22.90
04.5007	110	100	16	128	226	180	22	18	8	M16	3		1.500	28.10
04.5009	125	100	16	135	226	180	23	18	8	M16	3		1.500	28.10
04.5010	140	125	16	158	261	210	25	18	8	M16	3		2.000	39.30
04.5011	160	150	16	178	296	240	28	22	8	M20	3		2.500	48.40
04.5012	180	150	16	188	296	240	27	22	8	M20	3		2.300	48.40
04.5013	200	200	16	235	350	295	32	22	8	M20	4		3.600	70.20
04.5014	225	200	16	238	350	295	31	22	8	M20	4		3.500	70.20
04.5015	250	250	16	288	412	350	36	22	12	M20	4		5.400	89.–
04.5016	280	250	16	294	412	350	35	22	12	M20	4		5.300	89.–
04.5017	315	300	16	338	462	400	42	22	12	M20	4		7.200	129.80
04.5018	355	350	16	376	525	460	52	22	16	M20	6		11.900	258.30
04.5019	400	400	16	430	586	515	56	26	16	M24	6		16.100	293.40
04.5020	450	500	10	514	690	620	54.5	27	20	M24	6		22.400	620.50
04.5021	500	500	10	530	690	620	55	27	20	M24	6		21.300	620.50
04.5022	560	600	10	615	804	725	62	30	20	M27	6		33.200	758.20
04.5023	630	600	10	642	804	725	62	30	20	M27	6		30.600	926.70

n: número de agujeros

n: quantità di fori

n: number of holes

IPP DELTAFLEX® Brida DFD 21
Brida métrica/dimensiones ISO/DIN
Brida libre, fundición esférica, GGG 40, galvanizada en caliente
Con revestimiento plástico (negro)
Dimensiones: ISO/DIN 2501 PN 10
PN 16 (DA 200–400)
Factor de seguridad: 2,0 (todas las dimensiones)

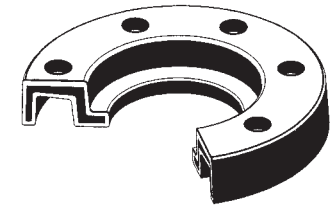

DFD 21 – Flangia metrica, Dimensioni ISO/DIN
Flangia libera, ghisa sferoidale GGG 40, zincata a caldo e
rivestita in plastica (nera)
Dimensioni: ISO/DIN 2501 PN 10/PN (DA 200–400)
Fattore di sicurezza: 2,0 (tutte le dimensioni)

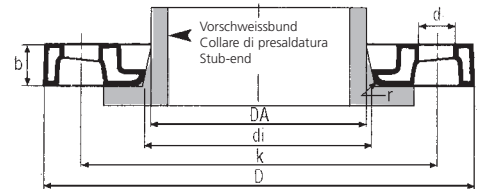

DF2DI – Metric Flanges ISO/DIN PN 10
Backup Rings, Ductile Iron (GGG 40), hot dipped galvanized
and epoxy coated (black)
Material: Ductile Iron, GGG 40 (hot dipped galvanized epoxy coated)
Drilling: ISO/DIN 2501 PN 10 (bolt hole circle PN 10)
Safety Factor: 2,0 (all diameters)

N° art. N. Articolo Article no	DA mm	DN	bar	di mm	D mm	k mm	b mm	d mm	n	M mm	Nm	r	Peso Peso Weight kg	Precio Prezzo Price EUR
04.5024	50	40	16	62	150	110	14	18	4	M16	50	3	1.100	12.90
04.5025	63	50	16	78	165	125	14	18	4	M16	50	3	1.400	14.–
04.5026	75	65	16	92	185	145	14	18	4	M16	50	3	1.700	17.60
04.5027	90	80	16	108	200	160	16	18	8	M16	50	3	1.900	20.20
04.5028	110	100	16	128	220	180	16	18	8	M16	50	3	2.000	23.–
04.5029	125	100	16	135	220	180	16	18	8	M16	50	3	2.000	24.10
04.5030	140	125	16	158	250	210	16	18	8	M16	75	3	2.300	27.70
04.5031	160	150	16	178	285	240	16	22	8	M20	75	3	2.800	34.50
04.5032	180	150	16	188	285	240	16	22	8	M20	90	3	2.500	34.50
04.5033	200	200	10	235	340	295	18	22	8	M20	120	3	4.000	46.60
04.5034	200	200	16	235	340	295	23	22	12	M20	120	4	4.200	53.10
04.5035	225	200	10	238	340	295	18	22	8	M20	120	3	3.600	46.60
04.5036	225	200	16	238	340	295	23	22	12	M20	120	3	4.000	53.10
04.5037	250	250	10	288	395	350	22	22	12	M20	150	3	6.100	70.40
04.5038	250	250	16	288	405	355	28	26	12	M24	150	3	6.900	86.80
04.5039	280	250	10	294	395	350	22	22	12	M20	150	3	5.700	70.40
04.5040	280	250	16	294	405	355	28	26	12	M24	150	3	6.700	86.80
04.5041	315	300	10	338	445	400	26	22	12	M20	180	3	7.800	86.80
04.5042	315	300	16	338	460	410	34	26	12	M24	180	3	9.200	110.50
04.5043	355	350	10	376	505	460	30	22	16	M20	225	4	12.400	150.20
04.5045	400	400	10	430	565	515	34	26	16	M24	280	4	15.100	188.–
04.5047	450	500	10	517	670	620	42	26	20	M24	350	6	22.500	269.70
04.5048	500	500	10	533	670	620	38	26	20	M24	400	4	23.300	269.70

Dim. 560 - 1200 mm: consultar precio/Prezzo su richiesta/Price on request

Ángulo 11°, soldado a tope
Gomito 11°, a saldatura di testa
Elbow 11°, segment-welded

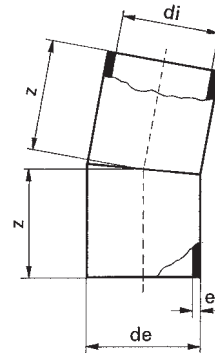

N° art. N. Articolo Article no	de mm	e mm	di mm	z mm	Peso Peso Weight kg	Precio Prezzo Price EUR
S 5/PN 16/SDR 11						
04.7783	63	5.8	51.4	156	0.315	30.60
04.7784	75	6.8	61.4	157	0.440	35.30
04.7785	90	8.2	73.6	209	0.650	41.10
04.7786	110	10.0	90.0	211	1.000	48.20
04.7787	125	11.4	102.2	212	1.300	56.-
04.7788	140	12.7	114.6	212	1.850	73.20
04.7789	160	14.6	130.8	215	2.150	75.10
04.7790	180	16.4	147.2	218	2.700	84.90
04.7791	200	18.2	163.6	220	4.400	97.80
04.7792	225	20.5	184.0	222	5.450	112.80
04.7793	250	22.7	204.6	224	6.900	129.40
04.7794	280	25.4	229.2	219	9.000	157.-
04.7795	315	28.6	257.8	221	11.450	225.20
04.7796	355	32.3	290.4	224	14.830	287.70
04.7797	400	36.4	327.2	227	19.000	359.50
S 8/PN 10/SDR 17						
04.7768	63	3.8	55.4	150	0.291	29.-
04.7769	75	4.5	66.0	150	0.411	32.40
04.7770	90	5.4	79.2	206	0.435	38.20
04.7771	110	6.6	96.8	207	0.660	43.70
04.7772	125	7.4	110.2	208	0.835	49.80
04.7773	140	8.3	123.4	209	1.180	65.-
04.7774	160	9.5	141.0	211	1.365	66.80
04.7775	180	10.7	158.6	212	1.725	74.90
04.7776	200	11.9	176.2	213	2.835	85.60
04.7777	225	13.4	198.2	215	3.595	98.-
04.7778	250	14.8	220.4	217	4.415	111.30
04.7779	280	16.6	246.8	219	6.110	132.90
04.7780	315	18.7	277.6	221	7.740	178.80
04.7781	355	21.1	312.8	224	10.070	287.-
04.7782	400	23.7	352.6	327	13.000	359.50

Ángulo 15°, soldado a tope
Gomito 15°, a saldatura di testa
Elbow 15°, segment-welded

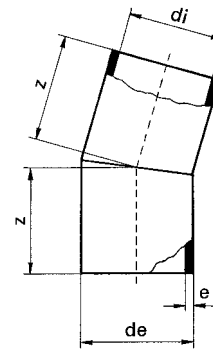

N° art. N. Articolo Article no	de mm	e mm	di mm	z mm	Peso Peso Weight kg	Precio Prezzo Price EUR
S 5/PN 16/SDR 11						
04.7813	63	5.8	51.4	156	0.315	30.60
04.7814	75	6.8	61.4	157	0.440	35.30
04.7815	90	8.2	73.6	209	0.650	41.10
04.7816	110	10.0	90.0	211	1.000	48.20
04.7817	125	11.4	102.2	212	1.300	56.–
04.7818	140	12.7	114.6	212	1.850	73.20
04.7819	160	14.6	130.8	215	2.150	75.10
04.7820	180	16.4	147.2	218	2.700	84.90
04.7821	200	18.2	163.6	220	4.400	97.80
04.7822	225	20.5	184.0	222	5.450	112.80
04.7823	250	22.7	204.6	224	6.900	129.40
04.7824	280	25.4	229.2	219	9.000	157.–
04.7825	315	28.6	257.8	221	11.450	225.20
04.7826	355	32.3	290.4	224	14.830	287.70
04.7827	400	36.4	327.2	227	19.000	359.50
S 8/PN 10/SDR 17						
04.7798	63	3.8	55.4	150	0.291	29.–
04.7799	75	4.5	66.0	150	0.411	32.40
04.7800	90	5.4	79.2	206	0.435	38.20
04.7801	110	6.6	96.8	207	0.660	43.70
04.7802	125	7.4	110.2	208	0.835	49.80
04.7803	140	8.3	123.4	209	1.180	65.–
04.7804	160	9.5	141.0	211	1.365	66.80
04.7805	180	10.7	158.6	212	1.725	74.90
04.7806	200	11.9	176.2	213	2.835	85.60
04.7807	225	13.4	198.2	215	3.595	98.–
04.7808	250	14.8	220.4	217	4.415	111.30
04.7809	280	16.6	246.8	219	6.110	132.90
04.7810	315	18.7	277.6	221	7.740	178.80
04.7811	355	21.1	312.8	224	10.070	287.–
04.7812	400	23.7	352.6	227	13.000	359.50

Ángulo 22°, soldado a tope
Gomito 22°, a saldatura di testa
Elbow 22°, segment-welded

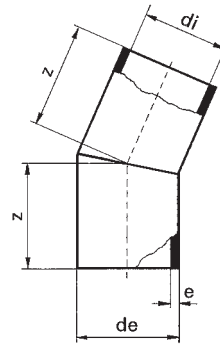

Nº art. N. Articolo Article no	de mm	e mm	di mm	z mm	Peso Peso Weight kg	Precio Prezzo Price EUR
S 5/PN 16/SDR 11						
04.7843	63	5.8	51.4	156	0.315	30.60
04.7844	75	6.8	61.4	157	0.440	35.30
04.7845	90	8.2	73.6	209	0.650	41.10
04.7846	110	10.0	90.0	211	1.000	48.20
04.7847	125	11.4	102.2	212	1.300	56.–
04.7848	140	12.7	114.6	212	1.850	73.20
04.7849	160	14.6	130.8	215	2.150	75.10
04.7850	180	16.4	147.2	218	2.700	84.90
04.7851	200	18.2	163.6	220	4.400	97.80
04.7852	225	20.5	184.0	222	5.450	112.80
04.7853	250	22.7	204.6	224	6.900	129.40
04.7854	280	25.4	229.2	219	9.000	157.–
04.7855	315	28.6	257.8	221	11.450	225.60
04.7856	355	32.3	290.4	224	14.830	287.70
04.7857	400	36.4	327.2	227	19.000	359.50
S 8/PN 10/SDR 17						
04.7828	63	3.8	55.4	150	0.291	29.–
04.7829	75	4.5	66.0	150	0.411	32.40
04.7830	90	5.4	79.2	206	0.435	38.20
04.7831	110	6.6	96.8	207	0.660	43.70
04.7832	125	7.4	110.2	208	0.835	49.80
04.7833	140	8.3	123.4	209	1.180	65.–
04.7834	160	9.5	141.0	211	1.365	66.80
04.7835	180	10.7	158.6	212	1.725	74.90
04.7836	200	11.9	176.2	213	2.835	85.60
04.7837	225	13.4	198.2	215	3.595	98.–
04.7838	250	14.8	220.4	217	4.415	111.30
04.7839	280	16.6	246.8	219	6.110	132.90
04.7840	315	18.7	277.6	221	7.740	178.80
04.7841	355	21.1	312.8	224	10.070	287.–
04.7842	400	23.7	352.6	227	13.000	359.50

Ángulo 30°, soldado a tope
Gomito 30°, a saldatura di testa
Elbow 30°, segment-welded

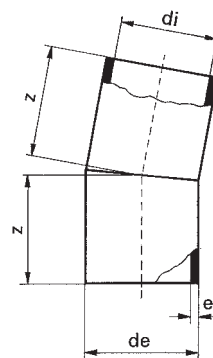

N° art. N. Articolo Article no	de mm	e mm	di mm	z mm	mm	Peso Peso Weight kg	Precio Prezzo Price EUR
S 5/PN 16/SDR 11							
04.7903	63	5.8	51.4	200	156	0.315	30.60
04.7904	75	6.8	61.4	200	157	0.440	35.30
04.7905	90	8.2	73.6	250	209	0.650	41.10
04.7906	110	10.0	90.0	250	211	1.000	48.20
04.7907	125	11.4	102.2	250	212	1.300	56.-
04.7908	140	12.7	114.6	250	212	1.850	73.20
04.7909	160	14.6	130.8	250	215	2.150	75.10
04.7910	180	16.4	147.2	250	218	2.700	84.90
04.7911	200	18.2	163.6	300	220	4.400	97.80
04.7912	225	20.5	184.0	300	222	5.450	112.80
04.7913	250	22.7	204.6	300	224	6.900	129.40
04.7914	280	25.4	229.2	300	219	9.000	157.-
04.7915	315	28.6	257.8	300	221	11.450	225.60
04.7916	355	32.3	290.4	350	224	14.830	287.70
04.7917	400	36.4	327.2	350	227	19.000	359.50
04.7888	63	3.8	55.4	200	150	0.291	29.-
04.7889	75	4.5	66.0	200	150	0.411	32.40
04.7890	90	5.4	79.2	250	206	0.435	38.20
04.7891	110	6.6	96.8	250	207	0.660	43.70
04.7892	125	7.4	110.2	250	208	0.835	49.80
04.7893	140	8.3	123.4	250	209	1.180	65.-
04.7894	160	9.5	141.0	250	211	1.365	66.80
04.7895	180	10.7	158.6	250	212	1.725	74.90
04.7896	200	11.9	176.2	300	213	2.835	85.60
04.7897	225	13.4	198.2	300	215	3.595	98.-
04.7898	250	14.8	220.4	300	217	4.415	111.30
04.7899	280	16.6	246.8	300	219	6.110	132.90
04.7900	315	18.7	277.6	300	221	7.740	178.80
04.7901	355	21.1	312.8	350	224	10.070	287.-
04.7902	400	23.7	352.6	350	227	13.000	359.50

Tubuladura con manguito roscado de PE100 adaptador PE sobre manguito roscado de fundición

* Al efectuar el pedido, indicar el tipo de anillo roscado.
Otras medidas a petición.

Raccordo con manicotto a vite in PE100 adattatore PE a vite in ghisa

* Nell'ordine, siete pregati di indicare il tipo di anello filettato.
Altre dimensioni a richiesta.

Screwing sleeve socket made of PE 100, Transition PE/cast iron

* For orders please indicate threaded ring manufacturer
Other dimensions on request

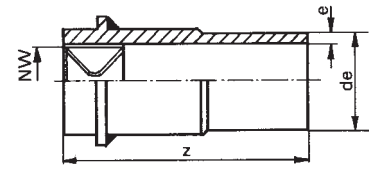

N° art. N. Articolo Article no	de mm	e mm	di mm	DN mm	z mm	Precio Prezzo Price EUR
S 5/PN 16/SDR 11						
04.3430	50	4.6	40.8	40	200	42.-
04.3431	63	5.8	51.4	50	200	44.20
04.3432	63	5.8	51.4	70	200	63.-
04.3433	75	6.8	61.4	70	200	65.20
04.3434	90	8.2	73.6	80	250	73.90
04.3435	110	10.0	90.0	100	250	90.30
04.3436	*125	11.4	102.2	100	280	124.60
04.3437	125	11.4	102.2	125	250	96.10
04.3438	140	12.7	114.6	125	250	115.90
04.3439	*160	14.6	130.8	125	280	158.70
04.3440	160	14.6	130.8	150	250	134.-
04.3441	*180	16.4	147.2	150	320	198.40
04.3442	200	18.2	163.6	200	250	189.80
04.3443	*225	20.5	184.0	200	390	267.30
04.3444	250	22.7	204.6	200	390	352.70
04.3445	250	22.7	204.6	250	250	360.70
04.3446	*280	25.4	229.2	250	390	585.90
04.3447	315	28.6	257.8	300	250	386.80
S 8/PN 10/SDR 17						
04.3410	50	3.0	40.8	40	200	42.-
04.3411	63	3.8	51.4	50	200	44.20
04.3412	63	3.8	51.4	70	200	63.-
04.3413	75	4.5	61.4	70	200	65.20
04.3414	90	5.4	73.6	80	250	73.90
04.3415	110	6.6	90.0	100	250	84.-
04.3416	*125	7.4	102.2	100	280	124.60
04.3417	125	7.4	102.2	125	250	99.30
04.3418	140	8.3	114.6	125	250	115.90
04.3419	*160	9.5	130.8	125	280	158.70
04.3420	160	9.5	130.8	150	250	134.-
04.3421	*180	10.7	147.2	150	320	198.40
04.3422	200	11.9	163.6	200	250	189.80
04.3423	*225	13.4	184.0	200	390	267.30
04.3424	250	14.8	204.6	200	390	352.70
04.3425	250	14.8	204.6	250	250	360.70
04.3426	*280	16.6	229.2	250	390	585.90
04.3427	315	18.7	257.8	300	250	386.80

Pieza de acoplamiento, igual
Giunto di accoppiamento uguale
Coupler, equal

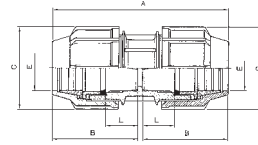

N° art. N. Articolo Article no	de mm	A mm	B mm	C mm	E mm	L mm	PN	GP	Peso Peso Weight kg	Código	Precio Prezzo Price EUR
06.2100	16	114	55	46	22	16.5	16	50	0.075	727 906 305	4.20
06.2101	20	114	55	46	22	15	16	50	0.070	727 906 306	5.20
06.2102	25	126	60	54	28	18	16	125	0.114	727 906 307	6.20
06.2103	32	131	64	64	34.5	18	16	75	0.158	727 906 308	7.70
06.2104	40	188	91.5	81.5	43.5	32	16	35	0.373	727 906 309	14.-
06.2105	50	207	102	93	53	33.5	16	25	0.505	727 906 310	19.60
06.2106	63	248	122	117	65	41.5	16	15	0.991	727 906 311	26.40
06.2107	75	290	143	134	77.5	53.5	10	12	1.392	727 906 312	50.10
06.2108	90	322	158	160	93	61	10	5	2.381	727 906 313	64.80
06.2109	110	362	178	181	113	71	10	3	3.191	727 906 314	123.30

Pieza de acoplamiento, reducido
Giunto di accoppiamento, ridotto
Coupler, reduced

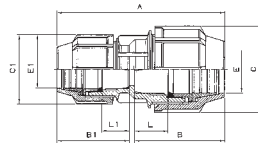

N° art. N. Articolo Article no	d-d1 mm	A mm	B mm	C mm	E mm	L mm	B1 mm	C1 mm	E1 mm	L1 mm	PN	GP	Peso Peso Weight kg	Código	Precio Prezzo Price EUR
06.2115	20-16	116	55.5	46	22	15	56	46	22	17	16	50	0.073	727 906 334	5.20
06.2117	25-20	133	62.5	54	28	20.5	55.5	46	22	15	16	125	0.100	727 906 337	6.30
06.2119	32-25	130	65	64	34.5	18	59	54	28	18	16	75	0.143	727 906 341	7.70
06.2120	40-25	160	93.5	81.5	43.5	34	63	54	28	21	16	50	0.279	727 906 347	13.70
06.2121	40-32	164	94	81.5	43.5	34	66	64	34.5	21.5	16	50	0.294	727 906 346	13.70
06.2123	50-32	175	102.5	93	53	34	69	64	34.5	24.5	16	25	0.380	727 906 353	19.20
06.2124	50-40	204	102.5	93	53	33.5	97	81.5	43.5	37.5	16	25	0.473	727 906 352	19.20
06.2128	63-50	216	117	117	65	38	96	93	53	27.5	16	15	0.760	727 906 358	26.40
06.2130	75-63	249	129	134	77.5	48	116	117	65	37	10	12	1.162	727 906 364	52.20
06.2131	90-63	355	188	160	93	87	160	117	65	82	10	6	1.793	727 906 371	64.80
06.2132	90-75	366	188	160	93	87	174.5	134	77.5	94	10	6	1.865	727 906 370	64.80
06.2133	110-90	411	211	181	113	92.5	195	160	93	87	10	4	2.769	727 906 376	120.50

Pieza de acoplamiento para reparaciones (sin tope central)

Giunto di accoppiamento per riparazioni (senza arresto centrale)

Repair-coupler

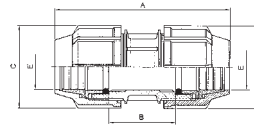

Nº art. N. Articolo Article no	de mm	A mm	B mm	C mm	EL mm	PB		GP	Peso Peso Weight kg	Código	Precio Prezzo Price EUR
06.2140	20	114	34	46	22	16		50	0.070	727 936 306	6.20
06.2141	25	126	43	54	28	16		125	0.114	727 936 307	6.90
06.2142	32	131	39	64	34.5	16		75	0.156	727 936 308	8.50
06.2143	40	188	68	81.5	43.5	16		35	0.384	727 936 309	14.50
06.2144	50	207	70	93	53	16		25	0.521	727 936 310	20.80
06.2145	63	248	86	117	65	16		15	1.011	727 936 311	28.70
06.2146	75	290	110	134	77.5	10		12	1.375	727 936 312	55.70
06.2147	90	322	128	160	93	10		5	2.369	727 936 313	67.70
06.2148	110	362	148	181	113	10		3	3.175	727 936 314	126.20

Racor de transición
con rosca hembra

Raccordo con filettatura
interna

Transition
with female thread

* con anillo de refuerzo
con anello di rinforzo
with backing-ring

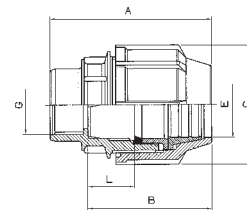

Nº art. N. Articolo Article no	de-G mm	A mm	B mm	C mm	E mm	L mm	PN	GP	Peso Peso Weight kg	Código	Precio Prezzo Price EUR
06.2255	16-1/2"	78	54	46	22	15	16	100	0.045	727 916 329	2.50
06.2256	16-3/4"	78	52	46	22	13	16	100	0.053	727 916 330	2.50
06.2257	20-1/2"	78	58	46	22	17	16	100	0.042	727 916 306	3.-
06.2258	20-3/4"	78	56.5	46	22	15.5	16	100	0.049	727 916 333	3.-
06.2259	25-1/2"	87	62.5	54	28	20.5	16	200	0.075	727 916 337	3.80
06.2260	25-3/4"	87	62.5	54	28	20.5	16	175	0.079	727 916 307	3.80
06.2261	25-1"	87	62.5	54	28	20.5	16	150	0.083	727 916 336	3.80
06.2262	32-3/4"	92	67	64	34.5	21	16	150	0.113	727 916 341	5.20
06.2263	32-1"	92	67	64	34.5	21	16	125	0.117	727 916 308	5.20
06.2264	32-1 1/4"	91	64	64	34.5	18	16	125	0.136	727 916 340	7.50
06.2265	40-1"	118	90	81.5	43.5	30	16	60	0.212	727 916 346	9.10
06.2266	*40-1 1/4"	118	89	81.5	43.5	29	16	60	0.209	727 916 309	9.10
06.2267	*40-1 1/2"	115	87	81.5	43.5	27	16	60	0.282	727 916 345	9.10
06.2279	*50-1"	123	100	93	53	30	16	40	0.293	727 916 353	12.60
06.2268	*50-1 1/4"	128	102	93	53	33	16	40	0.290	727 916 352	12.60
06.2269	*50-1 1/2"	128	99	93	53	30	16	40	0.319	727 916 310	12.50
06.2270	*50-2"	133	102	93	53	30	16	40	0.369	727 916 351	12.50
06.1940	*63-1 1/2"	158	128	117	65	50.5	16	20	0.596	727 916 358	16.50
06.2271	*63-2"	161	128	117	65	50.5	16	20	0.631	727 916 311	16.50
06.2272	*75-2"	169	135.5	134	77.5	55.5	10	18	0.806	727 916 364	33.-
06.2273	*75-2 1/2"	174	135.5	134	77.5	55.5	10	18	0.843	727 916 312	33.-

Racor de transición
con rosca hembra

Raccordo con filettatura
interna

Transition
with female thread

* con anillo de refuerzo
con anello di rinforzo
with backing-ring

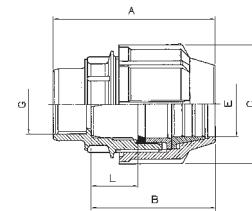

N° art. N. Articolo Article no	de-G mm	A mm	B mm	C mm	E mm	L mm	PN	GP	Peso Peso Weight kg	Código	Precio Prezzo Price EUR
06.2274	*90-2"	196	155	160	93	54.5	10	10	1.294	727 916 371	45.10
06.2280	*90-2 1/2"	210	170	160	93	68	10	10	1.359	727 916 372	45.10
06.2275	*90-3"	210	170	160	93	68	10	10	1.405	727 916 313	45.10
06.2277	*110-3"	215	170	181	113	48	10	6	1.784	727 916 376	73.20
06.2278	*110-4"	215	170	181	113	48	10	6	1.847	727 916 314	83.90

Racor de transición
con rosca macho

Raccordo con filettatura
esterna

Transition
with male thread

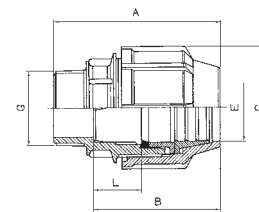

N° art. N. Articolo Article no	de-G mm	A mm	B mm	C mm	E mm	L mm	PN	GP	Peso Peso Weight kg	Código	Precio Prezzo Price EUR
06.2216	16-1/2"	76	58	46	22	20	16	100	0.042	727 926 329	2.50
06.2217	16-3/4"	76	58	46	22	20	16	100	0.045	727 926 330	2.50
06.2218	20-1/2"	76	56	46	22	15	16	100	0.041	727 926 306	2.90
06.2219	20-3/4"	77	55	46	22	15	16	100	0.042	727 926 333	2.90
06.2220	20-1"	79	55	46	22	15	16	100	0.045	727 926 332	2.90
06.2221	25-1/2"	83	63	54	28	20	16	75	0.063	727 926 337	3.80
06.2222	25-3/4"	84	63	54	28	20	16	75	0.064	727 926 307	3.80
06.2223	25-1"	86	64	54	28	21	16	75	0.067	727 926 336	3.80
06.2224	32-3/4"	88	68	64	34.5	19.5	16	150	0.087	727 926 341	5.40
06.2225	32-1"	92	70	64	34.5	20.5	16	150	0.090	727 926 308	5.40
06.2226	32-1 1/4"	94	70	64	34.5	21	16	150	0.092	727 926 340	5.40
06.2249	32-1 1/2"	96	70	64	34.5	20	16	125	0.110	727 926 339	5.40
06.2228	40-1"	120	95	81.5	43.5	35	16	60	0.207	727 926 346	8.40
06.2229	40-1 1/4"	120	93	81.5	43.5	33	16	60	0.209	727 926 309	8.40
06.2230	40-1 1/2"	120	93	81.5	43.5	33	16	60	0.210	727 926 345	8.40
06.2250	50-1"	125	100	93	53	28	16	40	0.300	727 926 353	12.10
06.2232	50-1 1/4"	132	102	93	53	34	16	40	0.288	727 926 352	12.10
06.2233	50-1 1/2"	132	102	93	53	34	16	40	0.285	727 926 310	12.10
06.2234	50-2"	140	103	93	53	35	16	40	0.298	727 926 351	12.10
06.2236	63-1 1/2"	154	119	117	65	41	16	20	0.548	727 926 358	16.-
06.2237	63-2"	156	119	117	65	41	16	20	0.567	727 926 311	16.-
06.2238	63-2 1/2"	160	119	117	65	41	16	20	0.577	727 926 357	16.-
06.2239	75-2"	173	135.5	134	77.5	55.5	10	18	0.758	727 926 364	31.40
06.2240	75-2 1/2"	174	135.5	134	77.5	55.5	10	18	0.759	727 926 312	31.40
06.2241	75-3"	178	135.5	134	77.5	55.5	10	18	0.779	727 926 363	31.40
06.2242	90-2"	205	168	160	93	68	10	10	1.306	727 926 371	43.-
06.2248	90-2 1/2"	210	168	160	93	68	10	10	1.306	727 926 372	43.-
06.2244	90-3"	210	168	160	93	68	10	10	1.322	727 926 313	43.-
06.2245	90-4"	216	168	160	93	68	10	10	1.356	727 926 369	43.-
06.2246	110-3"	226	178	181	113	71	10	6	1.725	727 926 376	67.-
06.2247	110-4"	231	178	181	113	71	10	6	1.728	727 926 314	67.-

POLYRAC® Uniones de compresión

POLYRAC® Raccordi di serraggio

POLYRAC® Compression fitting

Ángulo 90°

Gomito 90°

Elbow 90°

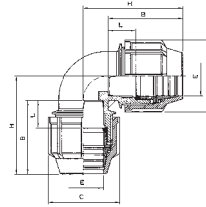

Nº art. N. Articolo Article no	de mm	B mm	C mm	E mm	L mm	H mm	PN	GP	Peso Peso Weight kg	Código	Precio Prezzo Price EUR
06.2150	16	58	46	22	18	71	16	50	0.081	727 106 305	4.20
06.2151	20	58	46	22	18	71	16	50	0.076	727 106 306	5.20
06.2152	25	62.5	54	28	20.5	77	16	25	0.128	727 106 307	6.70
06.2153	32	66	64	34.5	19	85	16	50	0.195	727 106 308	7.70
06.2154	40	86	81.5	43.5	27	117	16	30	0.406	727 106 309	13.50
06.2155	50	96.5	93	53	28	128	16	20	0.563	727 106 310	19.40
06.2156	63	114	117	65	35	160	16	10	1.128	727 106 311	26.10
06.2157	75	129	134	77.5	48	178	10	8	1.510	727 106 312	51.40
06.2158	90	163	160	93	62	235	10	3	2.709	727 106 313	64.80
06.2159	110	168	181	113	57	250	10	2	3.450	727 106 314	123.30

Ángulo 90° con rosca hembra

Gomito 90° con filettatura interna

Elbow 90° with female thread

* con anillo de refuerzo

* con anello di rinforzo

* with backing-ring

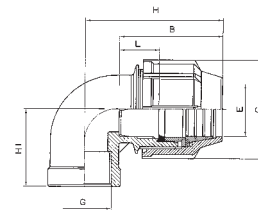

Nº art. N. Articolo Article no	de-G mm	B mm	C mm	E mm	L mm	H mm	H 1 mm	PN	GP	Peso Peso Weight kg	Código	Precio Prezzo Price EUR
06.1746	16-1/2"	58	46	22	18	71	48	16	75	0.058	727 116 329	3.60
06.1747	16-3/4"	58	46	22	18	71	53	16	75	0.062	727 116 330	3.60
06.1748	20-3/4"	58	46	22	18	71	48	16		0.059	727 116 333	4.20
06.1749	20-1/2"	58	46	22	18	71	53	16		0.055	727 116 306	4.20
06.1750	25-1/2"	63	54	28	20.5	77	53	16	50	0.091	727 116 337	5.-
06.1751	25-3/4"	63	54	28	20.5	77	53	16	50	0.093	727 116 307	5.-
06.1752	25-1"	63	54	28	20.5	77	60	16	50	0.096	727 116 336	5.-
06.1753	32-1/2"	66	64	34.5	19	85	60	16	100	0.149	727 116 342	6.-
06.1754	32-3/4"	66	64	34.5	19	85	60	16	100	0.151	727 116 341	6.-
06.1755	32-1"	66	64	34.5	19	85	60	16	100	0.139	727 116 308	6.-
06.1756	32-1 1/4"	68	64	34.5	22	88	45	16	75	0.142	727 116 340	6.-
06.1757	40-3/4"	87	81.5	43.5	27	120	53	16	50	0.277	727 116 347	10.80
06.1758	40-1"	87	81.5	43.5	27	120	53	16	50	0.264	727 116 346	10.80
06.1759	*40-1 1/4"	87	81.5	43.5	27	120	53	16	50	0.263	727 116 309	10.80
06.1760	*40-1 1/2"	83	81.5	43.5	23	120	53	16	50	0.280	727 116 345	10.80
06.1779	50-1"	96.5	93	53	28	130	62	10	35	0.378	727 116 318	
06.1761	*50-1 1/2"	96.5	93	53	28	130	62	16	35	0.378	727 116 310	15.30
06.1762	*50-2"	96.5	93	53	28	130	75	16	35	0.435	727 116 351	15.30
06.1763	*63-2"	114	117	65	35	160	70	16	15	0.741	727 116 311	19.60
06.1764	*75-2 1/2"	129	134	77.5	48	178	75	10	12	0.987	727 116 312	35.-
06.1765	*90-3"	163	160	93	62	235	100	10	6	1.699	727 116 313	64.20
06.1766	*110-4"	168	181	113	57	250	116	10	3	2.223	727 116 314	103.60

Ángulo 90°
con rosca macho

Gomito 90°
con filettatura esterna

Elbow 90°
with male thread

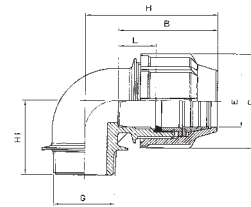

N° art. N. Articolo Article no	de-G mm	B mm	C mm	E mm	L mm	H mm	H 1 mm	PN	GP	Peso Peso Weight kg	Código	Precio Prezzo Price EUR
06.1767	16-1/2"	58	46	22	18	71	52	16	75	0.054	727 126 329	2.40
06.1768	16-3/4"	58	46	22	18	71	53	16	75	0.055	727 126 330	2.40
06.1769	20-1/2"	58	46	22	18	71	53	16	75	0.050	727 126 306	3.20
06.1770	20-3/4"	58	46	22	18	71	53	16	75	0.052	727 126 333	3.20
06.1771	25-1/2"	62.5	54	28	20.5	77	53	16	50	0.078	727 126 337	4.-
06.1772	25-3/4"	62.5	54	28	20.5	77	53	16	50	0.087	727 126 307	4.-
06.1773	25-1"	62.5	54	28	20.5	77	53	16	50	0.083	727 126 336	4.-
06.1774	32-1"	66	64	34.5	19	85	60	16	75	0.132	727 126 308	4.70
06.1780	40-1"	86	81.5	43.5	22.5	117	75	16	50	0.275	727 126 344	9.10
06.1775	40-1 1/4"	86	81.5	43.5	27	117	73	16	50	0.272	727 126 309	9.10
06.8093	40-1 1/1"	86	81.5	43.5	24	120	66	16	50	0.280	727 126 345	9.10
06.1776	50-1 1/4"	96.5	93	53	28	128	78	16	35	0.390	727 126 352	11.70
06.1777	50-1 1/2"	96.5	93	53	28	128	80	16	35	0.379	727 126 310	11.70
06.1778	63-2"	114	117	65	35	160	82	16	15	0.707	727 126 311	17.20

«T» 90°, igual
«T» 90°, uguale
Tee 90°, equal

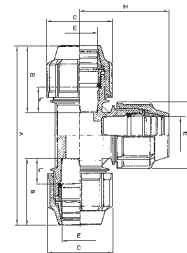

N° art. N. Articolo Article no	de mm	A mm	B mm	C mm	E mm	L mm	H mm	PN	GP	Peso Peso Weight kg	Código	Precio Prezzo Price EUR
06.2175	16	142	57	46	22	18	70	16	25	0.122	727 206 305	5.60
06.2176	20	143	58	46	22	18	72	16	25	0.112	727 206 306	7.50
06.2177	25	153	58	54	28	17	76	16	50	0.200	727 206 307	9.70
06.2178	32	175	65	64	34.5	19	87	16	30	0.240	727 206 308	12.80
06.2179	40	238	88	81.5	43.5	27	118	16	20	0.606	727 206 309	21.-
06.2180	50	259	96	93	53	27.5	128	16	12	0.818	727 206 310	28.70
06.2181	63	317	113	117	65	35	160	16	6	1.645	727 206 311	38.10
06.2182	75	360	129	134	77.5	48	180	10	5	2.203	727 206 312	69.10
06.2183	90	472	183	160	93	82	140	10	2	3.949	727 206 313	88.10
06.2184	110	512	193	181	113	80	260	10	1	5.008	727 206 314	150.80

«T» 90° con rosca hembra

«T» 90° con filettatura interna

Tee 90° with female thread

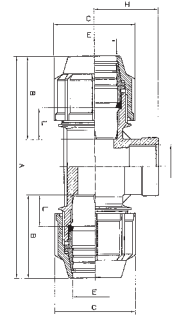

- * con anillo de refuerzo
- * con anello di rinforzo
- * with backing-ring

N° art. N. Articolo Article no	de-Rp-de mm	A mm	B mm	C mm	E mm	L mm	H mm	PN	GP	Peso Peso Weight kg	Código	Precio Prezzo Price EUR
06.1850	*63-2"-63	317	113	117	65	35	70	10	8	1.230	727 216 311	30.30
06.1851	*75-2 1/2"-75	360	129	134	77.5	48	75	10	8	1.689	727 216 312	51.20
06.1852	*90-3"-90	472	183	160	93	82	101	10	3	2.953	727 216 313	71.20
06.1853	*110-4"-110	512	193	181	113	80	115	10	2	3.750	727 216 314	101.80

«T» 90° con rosca macho

«T» 90° con filettatura esterna

Tee 90° with male thread

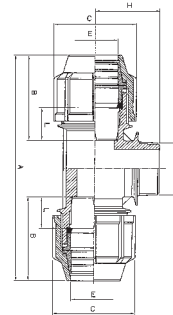

N° art. N. Articolo Article no	de-Rp-de mm	A mm	B mm	C mm	E mm	L mm	H mm	PN	GP	Peso Peso Weight kg	Código	Precio Prezzo Price EUR
06.1854	16-1/2"-16	142	58	46	22	19	50	16	25	0.095	727 226 329	3.40
06.1855	16-3/4"-16	142	58	46	22	19	50	16	25	0.094	727 226 330	3.40
06.1856	20-1/2"-20	143	58	46	22	18	50	16	25	0.087	727 226 306	6.-
06.1857	20-3/4"-20	143	58	46	22	18	50	16	25	0.090	727 226 333	6.-
06.1858	25-1/2"-25	153	58	54	28	17	52	16	25	0.137	727 226 337	8.-
06.1859	25-3/4"-25	153	58	54	28	17	52	16	25	0.137	727 226 307	8.-
06.1860	25-1"-25	153	58	54	28	17	52	16	25	0.134	727 226 336	8.-
06.1861	32-3/4"-32	175	65	64	34.5	19	58	16	45	0.211	727 226 341	9.20
06.1862	32-1"-32	175	65	64	34.5	19	59	16	45	0.205	727 226 308	9.20
06.1863	40-3/4"-40	238	88	81.5	43.5	27	82	16	30	0.444	727 226 347	17.60
06.1864	40-1 1/4"-40	238	88	81.5	43.5	27	73	16	30	0.459	727 226 309	17.60
06.1865	50-3/4"-50	259	96	93	53	27.5	86	16	16	0.608	727 226 354	22.60
06.1866	50-1 1/2"-50	259	96	93	53	27.5	80	16	16	0.664	727 226 310	22.60
06.1867	63-2"-63	317	113	117	65	35	82	16	8	1.160	727 226 311	33.10

«T» 90° reducido
«T» 90° ridotto
Tee 90°, reduced

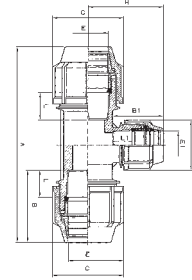

N° art. N. Articolo Article no	d-d ₁ -d mm	A mm	B mm	C mm	E mm	L mm	H mm	B1 mm	C1 mm	E1 mm	L1 mm	PN	GP	Peso Peso Weight kg	Código	Precio Prezzo Price EUR
06.2190	20-16-20	143	58	46	22	18	70	57	46	22	18	16	25	0.118	727 206 334	7.40
06.1829	20-25-20	144	58	54	22	18	76	59	46	28	17	16	25	0.123	727 206 335	7.40
06.2191	25-20-25	153	58	46	28	17	76	57.5	54	22	18	16	25	0.163	727 206 337	9.60
06.1830	25-32-25	155	59	54	28	17	80	55	54	34.5	19	16	45	0.194	727 206 338	9.60
06.2192	32-25-32	173	64	54	34.5	19	84	63	64	28	21	16	45	0.244	727 206 341	13.-
06.2193	40-32-40	238	87	64	43.5	27	97	66	81.5	34.5	21	16	20	0.515	727 206 346	28.-
06.1831	50-32-50	259	96	64	53	27.5	101	67.5	93	34.5	21	16	15	0.715	727 206 353	28.80
06.2194	50-40-50	259	96	81.5	53	27.5	125	94	93	43.5	38	16	12	0.790	727 206 352	28.80
06.2195	63-50-63	317	113	93	65	35	130	90	117	53	28	16	8	1.372	727 206 358	38.10
06.2196	75-63-75	360	129	117	77.5	48	163	113	134	65	35	10	5	2.033	727 206 364	69.10

«T» 90° con rosca hembra

«T» 90°, con filettatura interna

Tee 90°, with female thread

* con anillo de refuerzo
* con anello di rinforzo
* with backing-ring

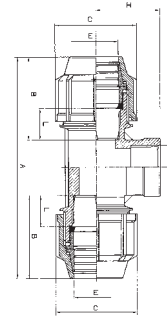

N° art. N. Articolo Article no	de-Rp-de mm	A mm	B mm	C mm	E mm	L mm	H mm	PN	GP	Peso Peso Weight kg	Código	Precio Prezzo Price EUR
06.1832	16-1/2"-16	142	57	46	22	18	48	16	25	0.099	727 216 329	4.20
06.1833	16-3/4"-16	142	58	46	22	19	53	16	25	0.104	727 216 330	4.20
06.1834	20-1/2"-20	143	58	46	22	18	48	16	25	0.092	727 216 306	6.70
06.1835	20-3/4"-20	143	58	46	22	18	53	16	25	0.096	727 216 333	6.70
06.1836	25-1/2"-25	153	59	54	28	17	52	16	25	0.148	727 216 337	7.30
06.1837	25-3/4"-25	153	59	54	28	17	52.5	16	25	0.148	727 216 307	7.30
06.1838	25-1"-25	153	59	54	28	17	59	16	25	0.147	727 216 336	7.30
06.1839	32-1/2"-32	175	65	64	34.5	19	59.5	16	45	0.228	727 216 342	9.40
06.1840	32-3/4"-32	175	65	64	34.5	19	59.5	16	45	0.224	727 216 341	9.40
06.1841	32-1"-32	175	65	64	34.5	19	59.5	16	45	0.230	727 216 308	9.40
06.1842	32-1 1/4"-32	175	65	64	34.5	19	45	16	45	0.240	727 216 340	9.40
06.1843	40-3/4"-40	238	87	81.5	43.5	27	53	16	35	0.472	727 216 347	15.30
06.1844	40-1"-40	238	87	81.5	43.5	27	53	16	35	0.463	727 216 346	15.30
06.1845	*40-1 1/4"-40	238	87	81.5	43.5	27	53	16	35	0.479	727 216 309	15.30
06.1885	*40-1 1/2"-40	238	83	81.5	43.5	24	53	16	35	0.479	727 216 345	15.30
06.1886	*50-1"-50	260	96.5	93	53	27.5	62.5	16	22	0.635	727 216 353	21.50
06.1846	*50-1 1/4"-50	260	96.5	93	53	27.5	62.5	16	22	0.648	727 216 352	21.50
06.1847	*50-1 1/2"-50	260	96.5	93	53	27.5	62.5	16	22	0.707	727 216 310	21.50
06.1848	*50-2"-50	260	96.5	93	53	27.5	75	16	18	0.707	727 216 351	21.50
06.1849	*63-1 1/2"-63	317	113	117	65	35	70	16	8	1.172	727 216 358	30.30

Racor con brida
Raccordo a vite con flangia
Threaded connection with flange

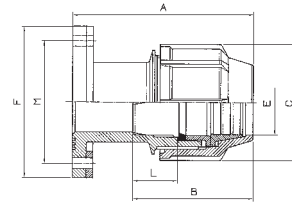

Nº art. N. Articolo Article no	de mm	A mm	B mm	C mm	E mm	L mm	M mm	F mm	PN	GP	Peso Peso Weight kg	Código	Precio Prezzo Price EUR
06.1899	50-2"	170	152	93	53	84	125	174	16	16	1.214	727 706 351	41.60
06.1868	63-2"	193	126	117	65	47.5	125	174	16	12	1.481	727 706 311	44.40
06.1869	63-2½"	195	127	117	65	48	145	185	16	12	1.823	727 706 357	45.80
06.1870	75-2½"	197	185	134	77.5	104	145	185	10	8	1.966	727 706 312	56.40
06.1871	75-3"	197	162	134	77.5	82	160	200	10	6	2.194	727 706 363	59.20
06.1872	90-3"	232	166	160	93	65	160	200	10	5	2.817	727 706 313	71.20
06.1873	90-4"	232	166	160	93	65	181	220	10	5	1.727	727 706 369	71.20
06.1874	110-4"	239	220	181	113	107	181	220	10	4	3.169	727 706 314	101.50

Tapón terminal
Tappo terminale
Spigot cap

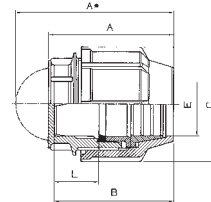

Nº art. N. Articolo Article no	de mm	A mm	B mm	C mm	E mm	L mm	PN	GP	Peso Peso Weight kg	Código	Precio Prezzo Price EUR
06.1875	16	60	58	46	22	19	16	100	0.041	727 966 305	2.30
06.1876	20	61	59	46	22	18	16	100	0.038	727 966 306	2.90
06.2200	25	67	62.5	54	28	20	16	75	0.060	727 966 307	3.80
06.2201	32	69	64	64	34.5	18	16	150	0.084	727 966 308	5.20
06.2202	40	99	91	81.5	43.5	31.5	16	60	0.210	727 966 309	8.60
06.2203	50	111	101	93	53	32	16	40	0.296	727 966 310	12.30
06.2204	63	158	120	117	65	41.5	16	20	0.571	727 966 311	15.90
06.2205	75	178	136	134	77.5	55.5	10	18	0.771	727 966 312	31.70
06.2206	90	216	168	160	93	68	10	10	1.342	727 966 313	43.70
06.2207	110	230	177	181	113	71	10	6	1.756	727 966 314	74.70

Abrazadera PP
Collare di congiuntura PP
Saddle PP



Nº art. N. Articolo Article no	de mm	PN	GP	Peso Peso Weight kg	Código	Precio Prezzo Price EUR
06.1887	32-½"	10	150	0.099	700 627 388	6.20
06.1877	32-¾"	10	100	0.107	700 627 389	6.20
06.1878	40-¾"	10	100	0.140	700 627 391	7.-
06.1879	40-1"	10	100	0.143	700 627 392	8.60
06.1880	50-¾"	10	100	0.190	700 627 394	14.50
06.1881	50-1"	10	100	0.150	700 627 395	20.80
06.1882	90-1"	10	35	0.413	700 627 409	28.80
06.1883	110-1¼"	10	20	0.457	700 627 416	55.70
06.1884	110-1½"	10	20	0.478	700 627 417	67.80



Gossau



HakaGerodur AG
Mooswiesstrasse 67
Postfach
CH-9200 Gossau SG
Telefon +41 (0)71 388 94 94
Fax +41 (0)71 388 94 80
sekretariat@hakagerodur.ch
www.hakagerodur.ch

Benken



HakaGerodur AG
Giessenstrasse 3
Postfach
CH-8717 Benken SG
Telefon +41 (0)55 293 25 25
Fax +41 (0)55 293 25 26
sekretariat@hakagerodur.ch
www.hakagerodur.ch

Neustadt in Sachsen



GERODUR MPM
Kunststoffverarbeitung GmbH & Co. KG
Andreas-Schubert-Strasse 6
D-01844 Neustadt in Sachsen
Telefon +49 (03596) 58 33-0
Fax +49 (03596) 60 24 04
info@gerodur.de
www.gerodur.de

Gamma di vendita completa

Divisione Riscaldamento +

Attrezzature sanitarie,

Gossau/Neustadt

- Tubi di riscaldamento a pavimento in PE-RT, PB e PE-X
- Tubi compositi multistrato in materia plastica/metallo
- Tubi di sanitari
- Tubi speciali, p.es. per sistemi di raffreddamento a soffitto o condotte per olio

Divisione Sistemi di tubazioni,

Benken/Neustadt

- Tubi a pressione in PE per gas/acqua/acque di scarico
- Tubi GEROfit® con guaina protettiva
- Tubazioni fognarie e di drenaggio
- Tubi di protezione per cavi
- Tubi di scarico delle acque domestiche
- Tubi per applicazioni industriali (trasporto di fluidi/gas)
- Parti in materiale sintetico confezionate

Divisione Sonde geotermiche, Benken

- Sistemi di tubazioni per lo sfruttamento dell'energia geotermica in prossimità della superficie, per climatizzazione (refrigerazione e riscaldamento) di stabili
- Ampia gamma di accessori

Divisione Produzione Profilati, Gossau

- Profilati in materie plastiche poliolefiniche/tecniche per industria meccanica, ingegneria ambientale, illuminazione, edilizia, mobilifici, tecnologie mediche, di laboratorio e quant'altro
- Produzione (CAD) con attrezzatura propria

Divisione Tecnologie Mediche (Gossau)

- Pipette sierologiche in polistirolo in diverse misure per utilizzo in laboratorio. Applicazione nella ricerca, nell'industria farmaceutica, nelle tecnologie mediche, nella cosmetica e nell'industria alimentare.

Programa completo de venta

Sector Calefacción e instalaciones sanitarias,

Gossau/Neustadt

- Tubos para calefacción de suelo de PE-RT, PB y PE-X
- Tubos de material compuesto multicapas de plástico/metal
- Tubos sanitarios
- Tubos especiales, por ej. para refrigeración de techos o tuberías de aceite

Sector Sistemas de tubos, Benken/Neustadt

- Tubos de presión PE para gas/agua/aguas residuales
- Tubos con camisa protectora GEROfit®
- Tubos de canalización y drenaje
- Tubos para protección de cables
- Tubos de evacuación de aguas servidas domésticas
- Tubos para aplicaciones industriales (transporte de líquidos/gas)
- Piezas sintéticas confeccionadas

Sector Sondas geotérmicas, Benken

- Sistemas de tubos para el aprovechamiento de la energía geotérmica cercana a la superficie para la climatización de edificios (refrigeración y calefacción)
- Amplio surtido de accesorios

Sector Perfiles, Gossau

- Perfiles de poliolefinas/materiales sintéticos técnicos para la industria de maquinaria, la técnica del medio ambiente, la iluminación, la construcción, la fabricación de muebles, la técnica medicinal y de laboratorios, etc.
- Construcción propia (CAD) con taller de herramientas

División de Técnica medicinal (Gossau)

- Pipetas serológicas de poliestireno en diversos tamaños para uso en el laboratorio. Aplicación en la investigación y en la industria farmacéutica, medicinal, cosmética y de alimentos.

Overall Sales Program

Heating and Sanitary Equipment Division,

Gossau/Neustadt

- Underfloor heating pipes made of PE-RT, PB and PE-X
- Multilayer laminated tubes made of plastic/metal
- Sanitary piping
- Special piping, e.g. for ceiling cooling systems and oil product supply lines

Pipe Systems Division, Benken/Neustadt

- PE pressure pipes for gas/water supply/waste water
- GEROfit® pipe with protective jacket
- Sewage and seepage pipes
- Cable ducts
- Domestic drainage pipes
- Pipes for industrial applications (to transport liquids/gases)
- Ready-made plastic parts

Geothermal Probes Division, Benken

- Pipework systems to exploit the geothermal energy near the surface of the earth for air-conditioning in buildings (cooling and heating)
- Comprehensive range of accessories

Product division profiled sections (Gossau)

- Profiled sections made of polyolefins/technical plastics, e.g. for machine building, environmental technology, lighting, construction, furniture.
- Own construction (CAD) with toolmaking

Medical Technology Division (Gossau)

- Serological pipettes extruded in polystyrene in variable sizes for the use in laboratories. Applications in research, pharma-, medical-, cosmetics- and food industries.

